

# 0124BAHU

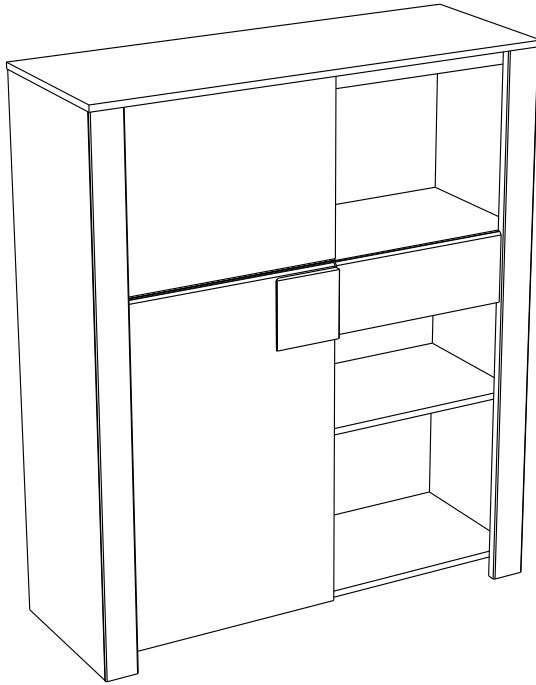

## FR Remerciements :

Nous vous remercions d'avoir choisi un meuble créé et fabriqué par le Groupe Parisot et espérons qu'il vous donnera entière satisfaction.

## EN Thanks:

Thank you for choosing furniture designed and manufactured by the Parisot Group. We hope you are totally satisfied with your purchase.

## DE Danksagung:

Wir danken Ihnen für den Kauf eines Frankreich von der Parisot-Gruppe entworfenen und hergestellten Möbelstücks und hoffen, dass Sie es zu Ihrer vollkommenen Zufriedenheit finden werden.

## ES Agradecimientos:

Les damos las gracias por haber elegido un mueble diseñado y fabricado por el Groupe Parisot y esperamos que sea de su total agrado.

## PT Agradecimentos:

Obrigado por ter escolhido um móvel concebido e fabricado pelo Grupo Parisot, esperando que seja do seu inteiro agrado.

## IT Ringraziamenti:

Grazie per avere scelto un mobile progettato e fabbricato dal Gruppo Parisot. Speriamo soddisfatti appieno le vostre esigenze.

## NL Bedankje:

Wij bedanken u voor de aankoop van een door de Groep Parisot ontworpen en vervaardigd meubel en hopen dat u er veel plezier aan zult beleven.

## CZ Poděkování:

Děkujeme, že jste si vybrali nábytek navržený a vyrobený společností Parisot Group. Doufáme, že budete svým nákupem naprosto spokojeni.

## HU Köszönet:

Köszönjük, hogy a Parisot Groupe által létrehozott és gyártott bútort választott, reméljük, hogy elégedett lesz a termékkel.

## PL Podziękowania:

Dziękujemy za wybór mebli stworzonych i wyprodukowanych przez Grupę Parisot. Mamy nadzieję, że będziecie Państwo w pełni zadowoleni z zakupu.

## RO Mulțumiri:

Vă mulțumim că ați ales un articol de mobilier conceput și fabricat de Grupul Parisot și sperăm că veți fi pe deplin satisfăcuți de acesta.

## RU Благодарность:

Мы благодарим вас за то, что вы выбрали мебель, созданную и произведенную Групп Паризо, и надеемся, что вы будете полностью удовлетворены нашей продукцией.

## SK Pod'akovanie:

Ďakujeme, že ste si vybrali nábytok navrhnutý a vyrobený spoločnosťou Parisot Group. Dúfame, že budete svojim nákupom absolútne spokojní.

## TR Teşekkür ederiz:

Parisot Group tarafından tasarlanan ve üretilen bu mobilyayı seçtiğiniz için teşekkür ederiz. Ürünümüzden memnun kalmanızı ümit ederiz.

## AR : شكر

نشكركم لاختياركم هذه القطعة من الأثاث من تصميم وتصنيع مجموعة باريسو Parisot ونتمنى أن تتلوا رضاهم.

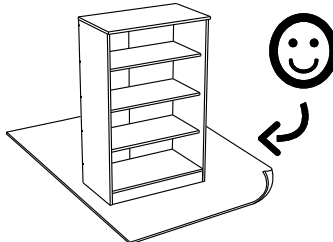
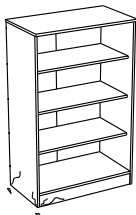
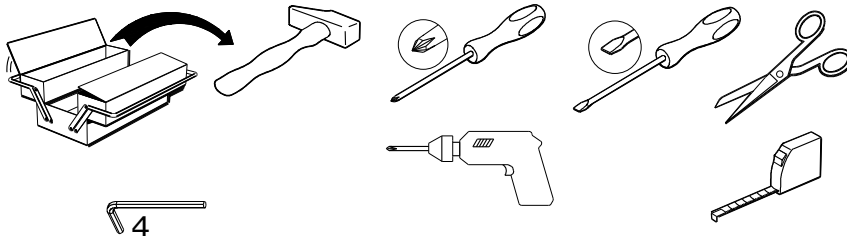

[contact@parisot.com](mailto:contact@parisot.com)

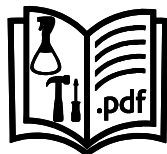

[www.parisot.com](http://www.parisot.com)

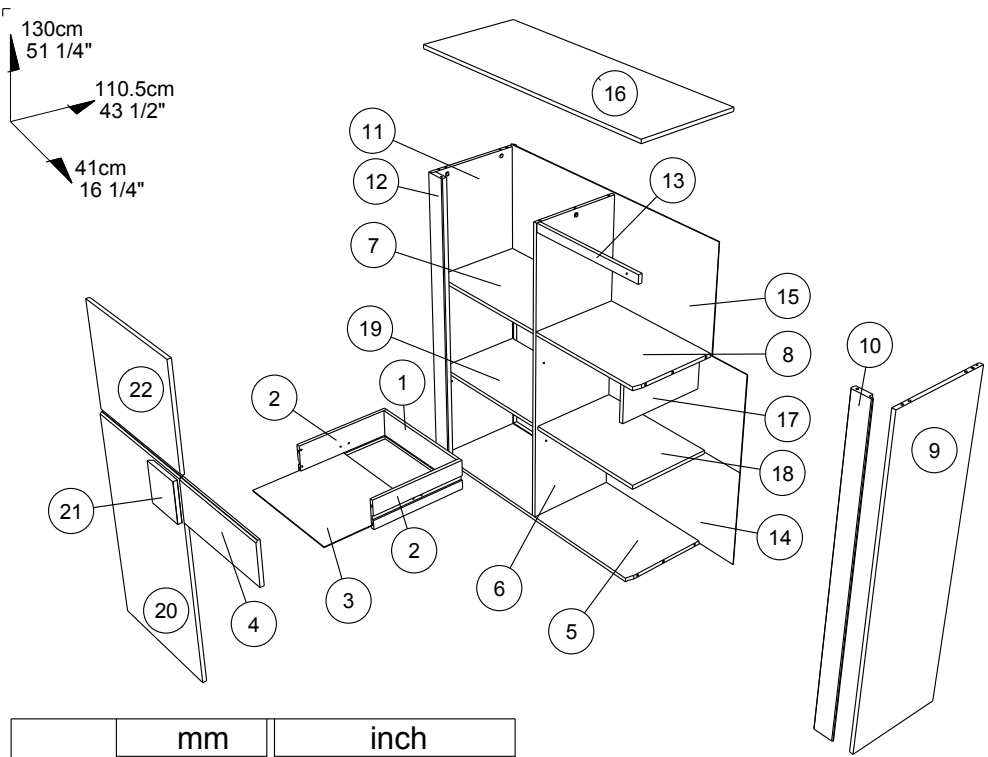

		mm			inch		
21	x 1	160	156	16	6 5/16	6 1/8	5/8
17	x 1	362	150	15	14 1/4	5 7/8	9/16
4	x 1	433	168	15	17 1/16	6 5/8	9/16
22	x 1	501	414	15	19 3/4	16 5/16	9/16
13	x 1	505	35	16	19 7/8	1 3/8	5/8
18	x 1	505	351	15	19 7/8	13 13/16	9/16
8	x 1	505	362	15	19 7/8	14 1/4	9/16
19	x 1	549	351	15	21 5/8	13 13/16	9/16
7	x 1	549	362	15	21 5/8	14 1/4	9/16
20	x 1	814	501	15	32 1/16	19 3/4	9/16
5	x 1	1069	382	15	42 1/16	15 1/16	9/16
16	x 1	1103	408	15	43 7/16	16 1/16	9/16
6	x 1	1219	362	15	48	14 1/4	9/16
10	x 1	1284	80	22	50 9/16	3 1/8	7/8
12	x 1	1284	80	22	50 9/16	3 1/8	7/8
9	x 1	1284	398	15	50 9/16	15 11/16	9/16
11	x 1	1284	398	15	50 9/16	15 11/16	9/16
2	x 2	350	110	13	13 3/4	4 5/16	1/2
1	x 1	389	110	13	15 5/16	4 5/16	1/2
3	x 1	400	349	3	15 3/4	13 3/4	1/8
15	x 1	1085	439	3	42 11/16	17 5/16	1/8
14	x 1	1085	795	3	42 11/16	31 5/16	1/8

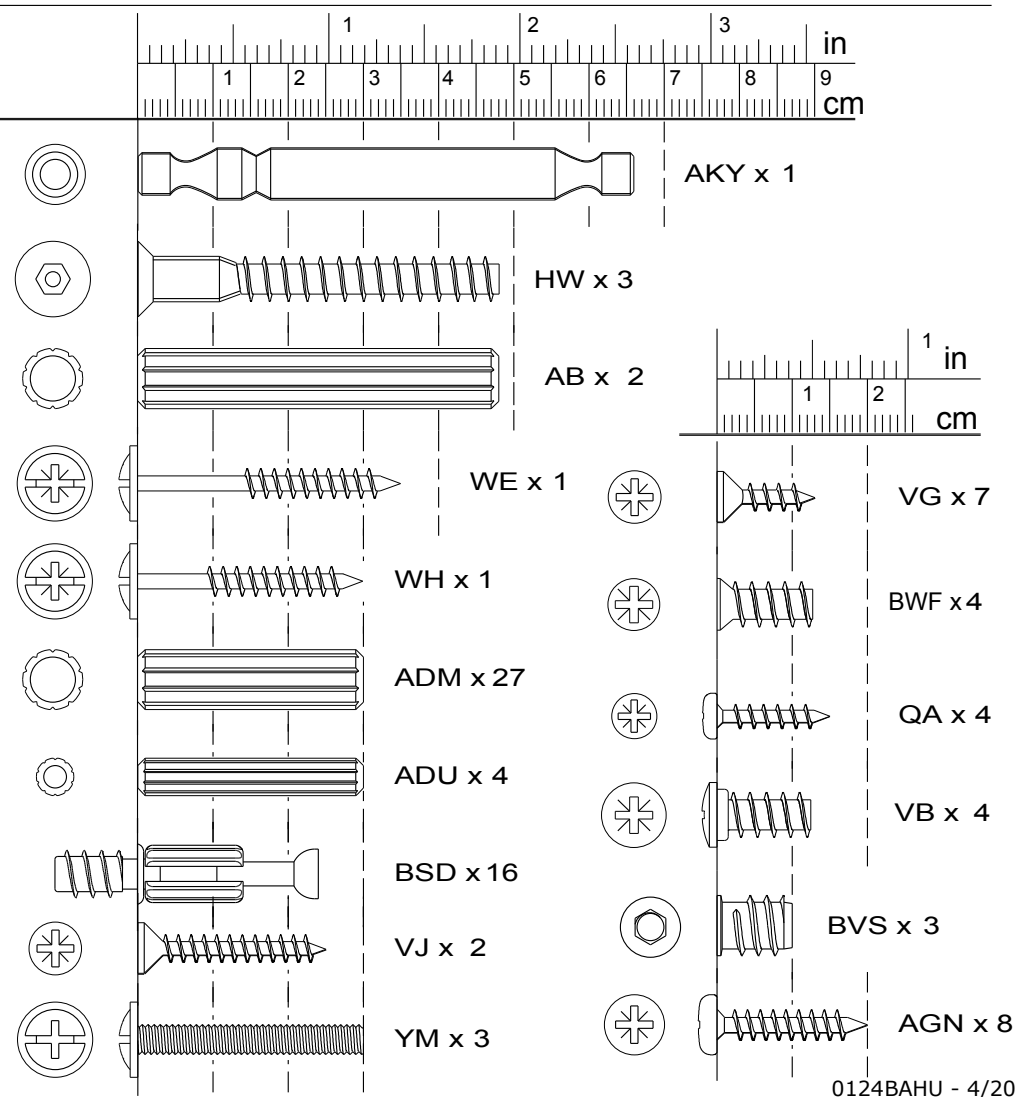
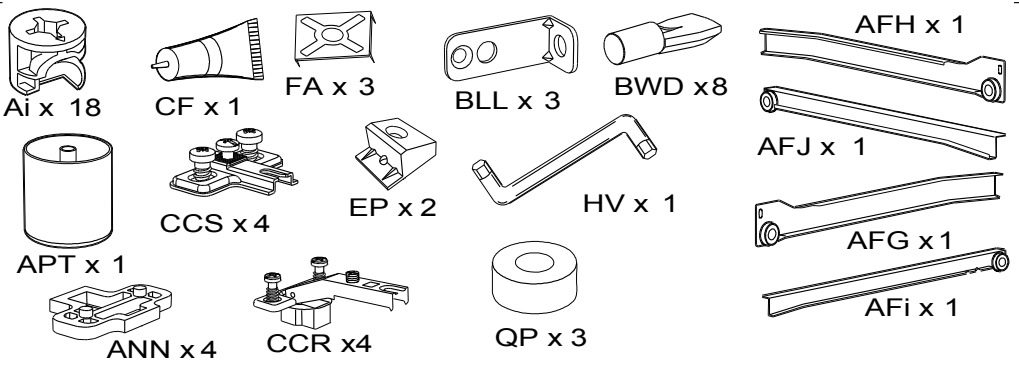

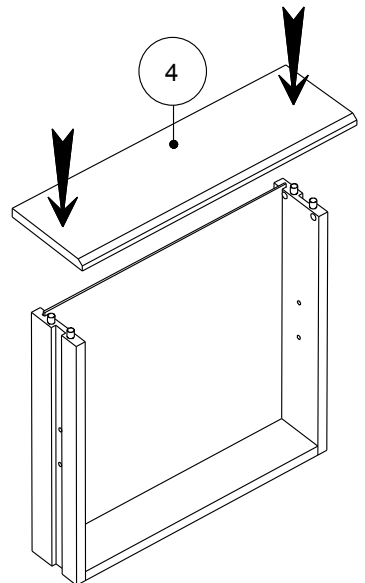
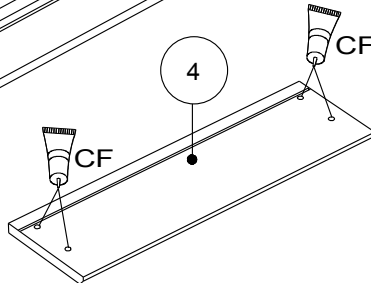
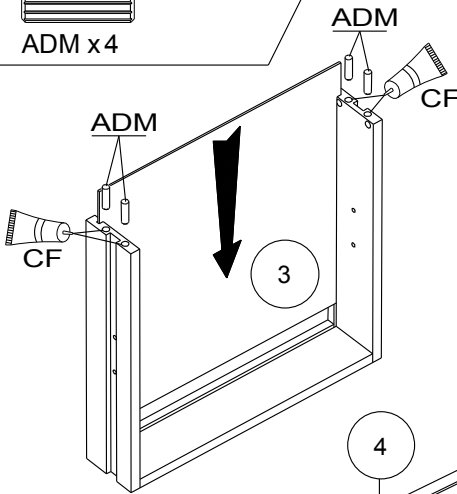
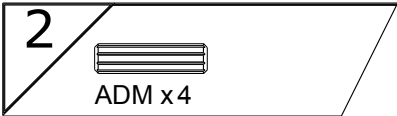
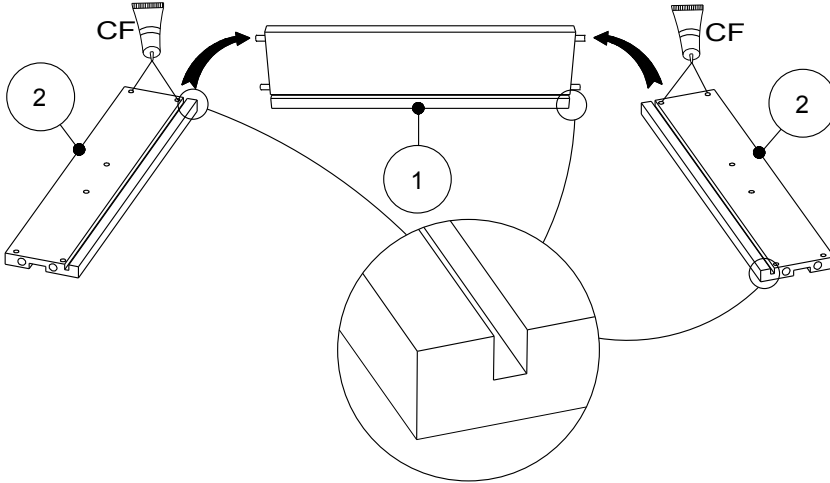
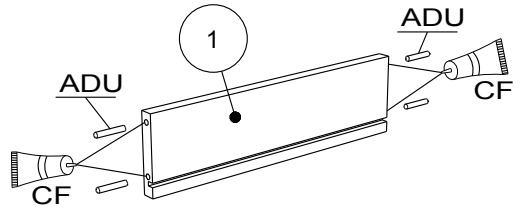
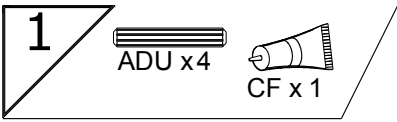

3

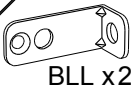

VB x 2



ADM x 7



AFG x 1



BWF x 2

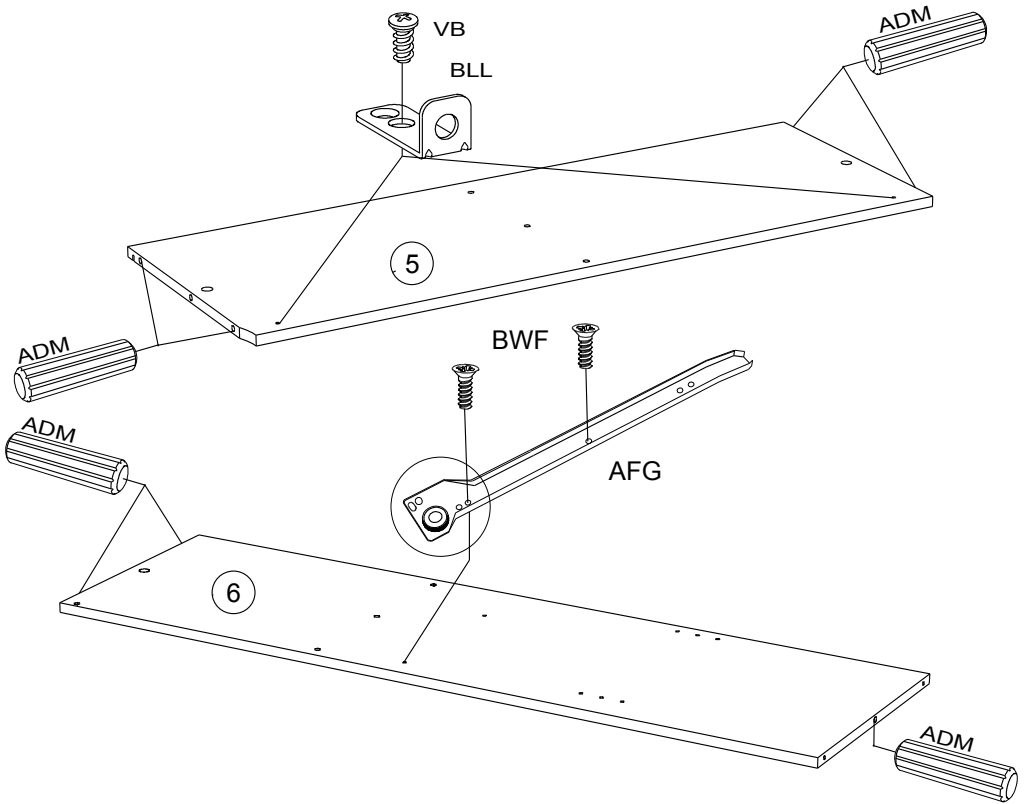

4

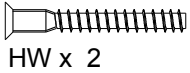

HW x 2

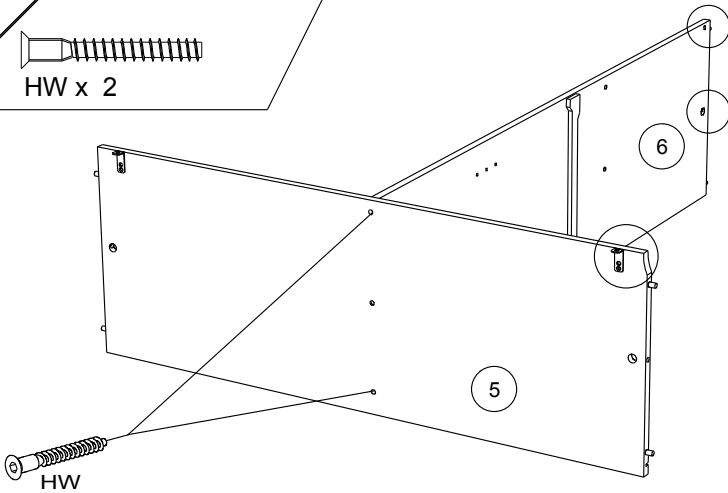

5



AB x 2



AKY x 1



Ai x 1



ADM x 4

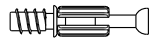

BSD x 1

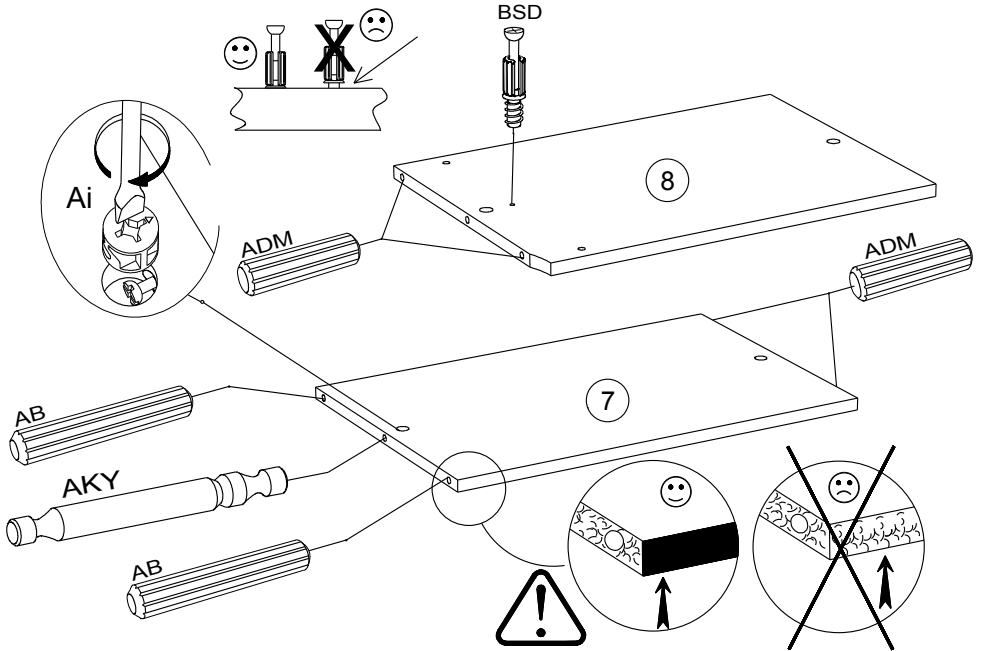

6



Ai x 1



APT x 1

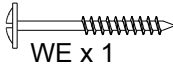

WE x 1

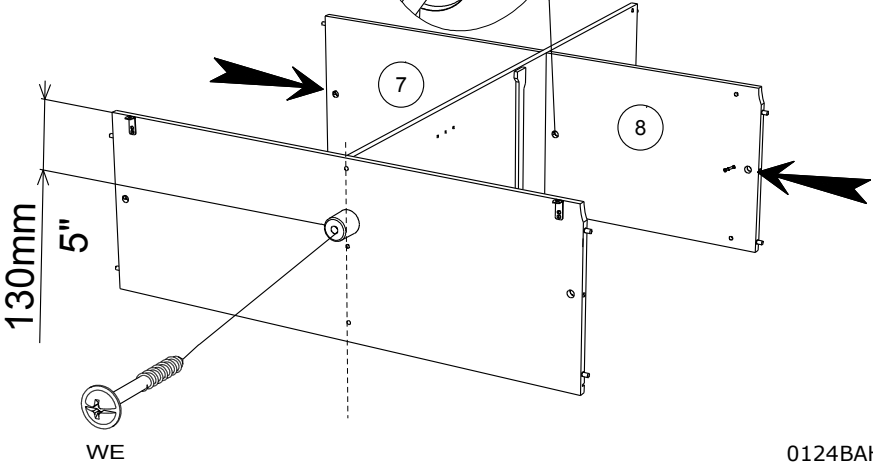
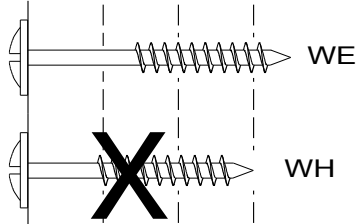
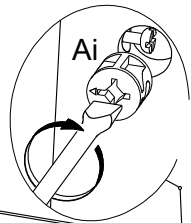

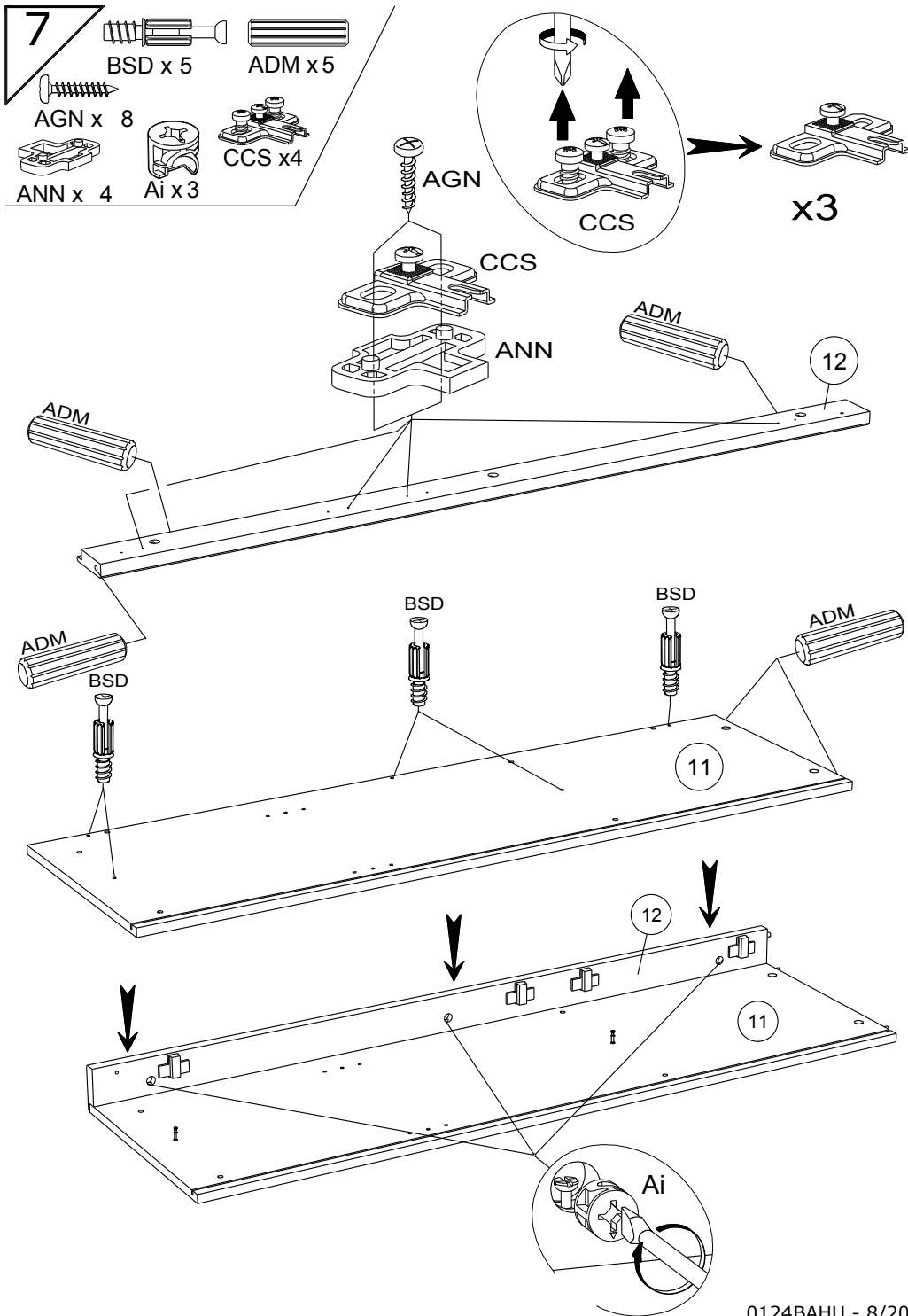



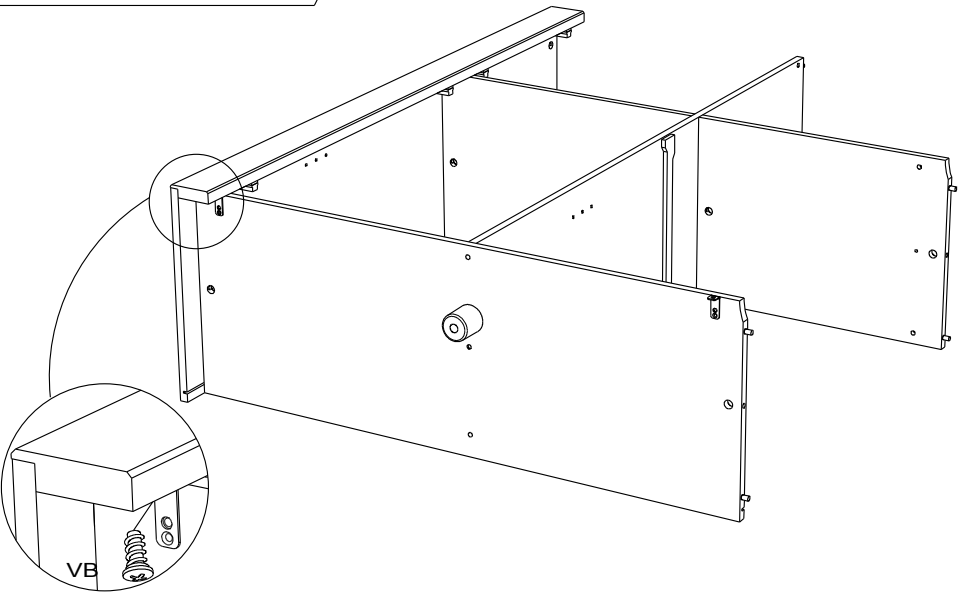
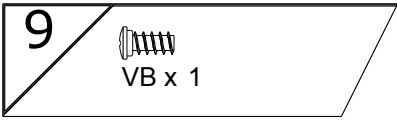
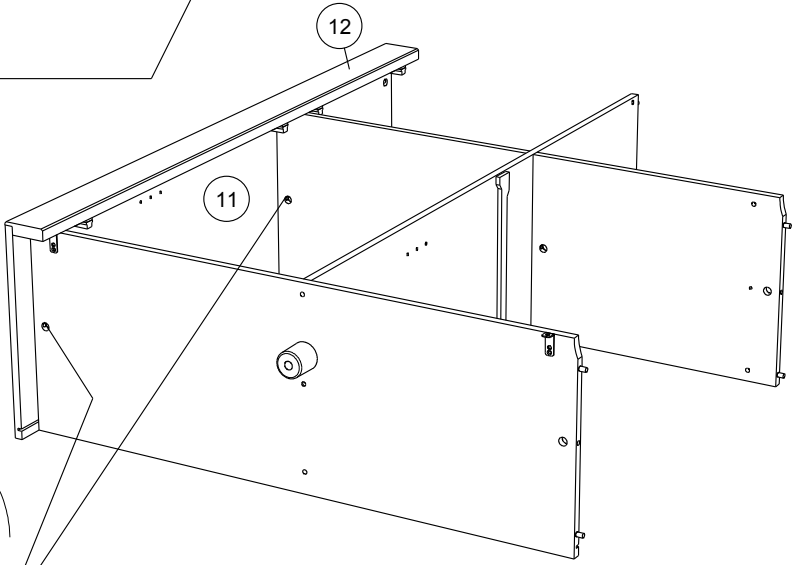
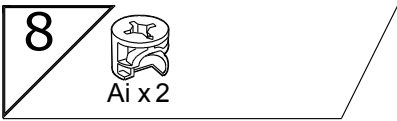

10



BSD x 5



Ai x 3



ADM x 5

10

ADM

ADM

BSD

BSD

9

ADM

10

9

Ai

11



Ai x 2



VB x 1

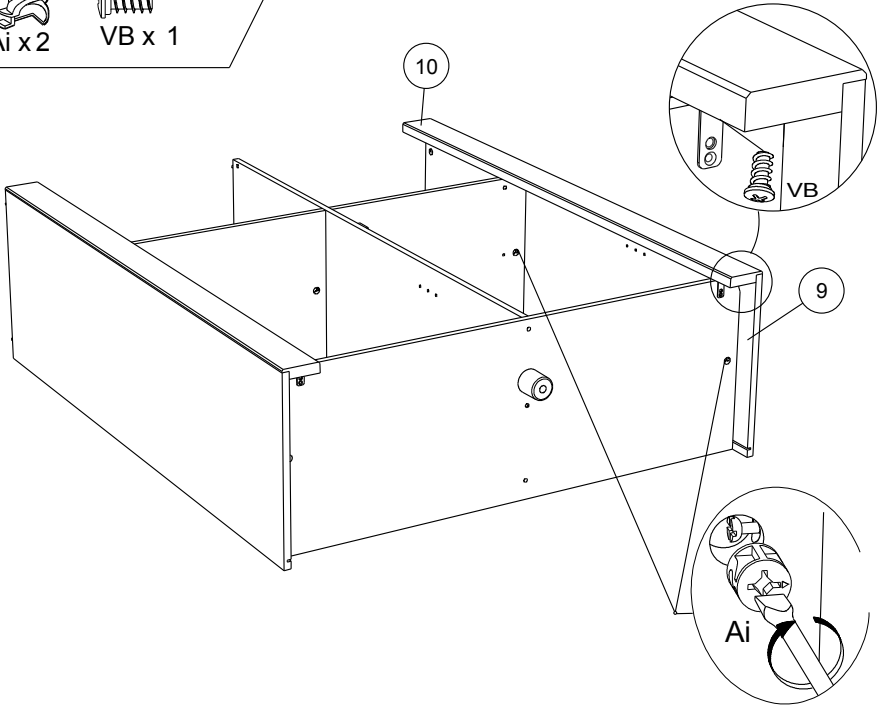

12

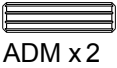

ADM x 2



BWF x 2

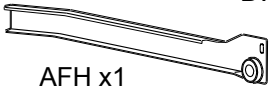

AFH x 1

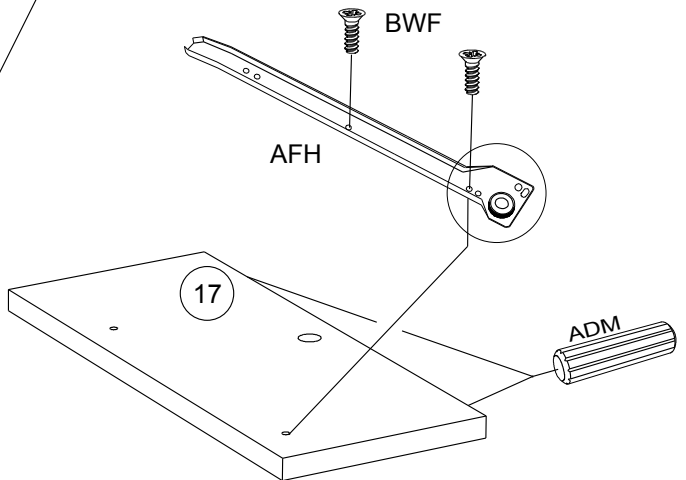

13

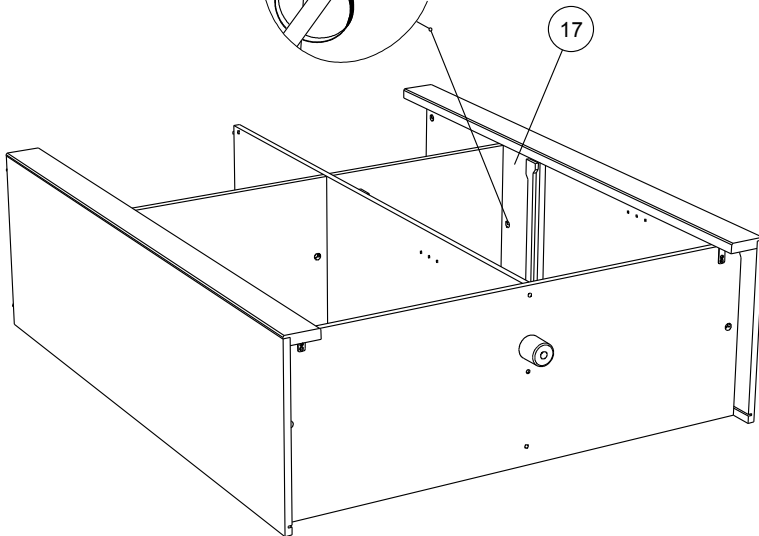
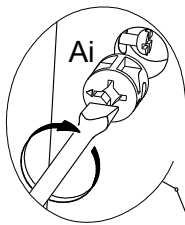

14

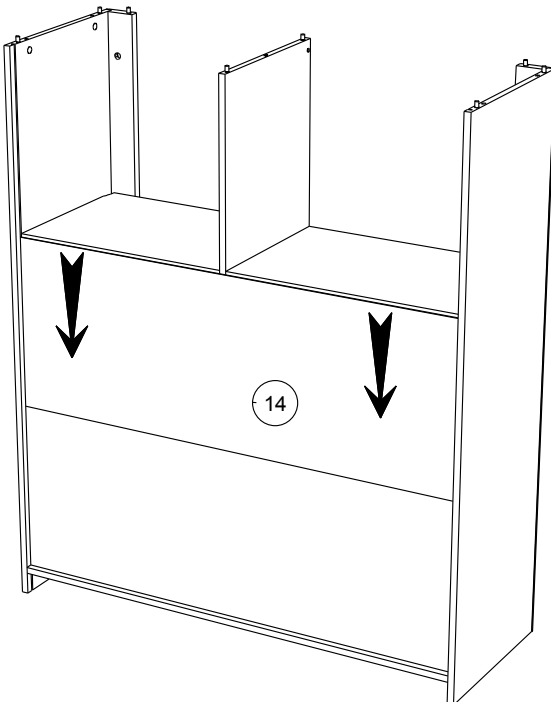

15

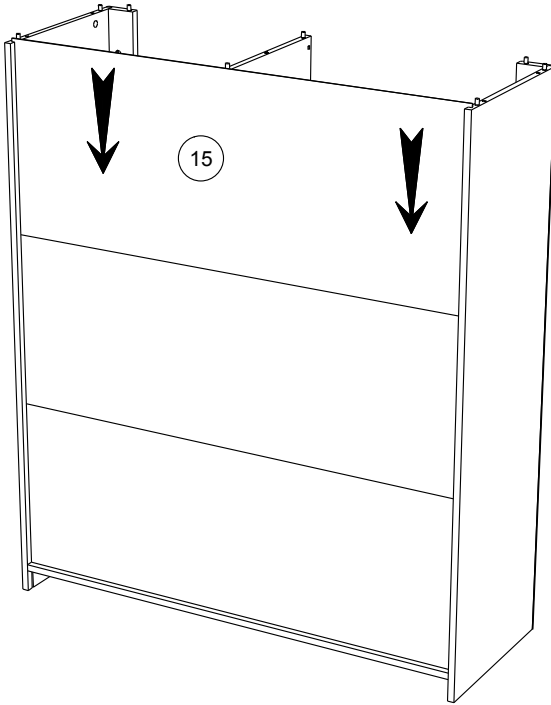

16

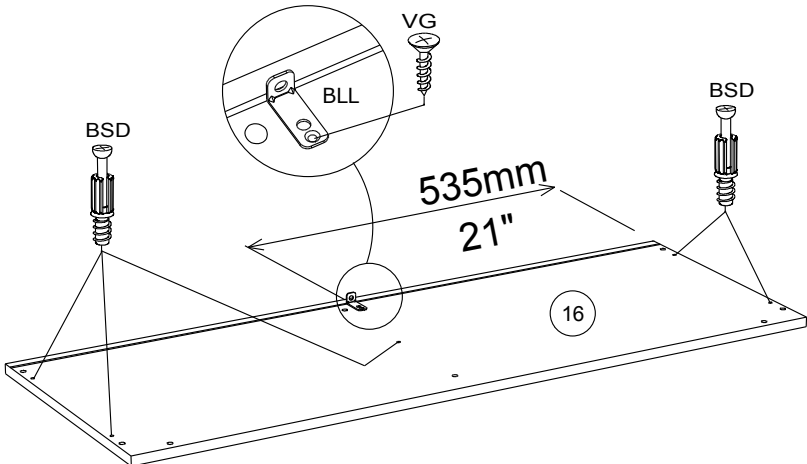
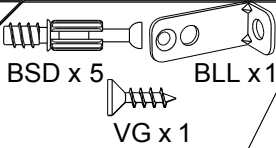

17



Ai x5

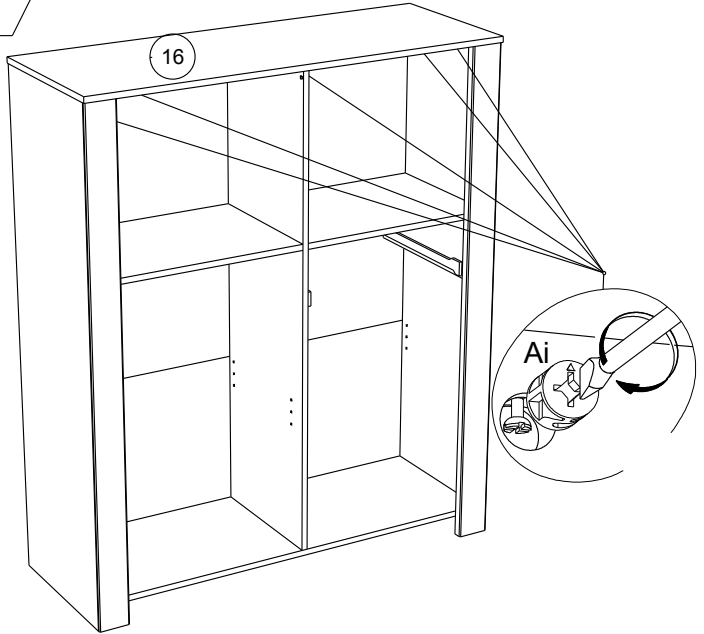

18



EP x2

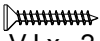

VJ x 2



FA x3



VG x3

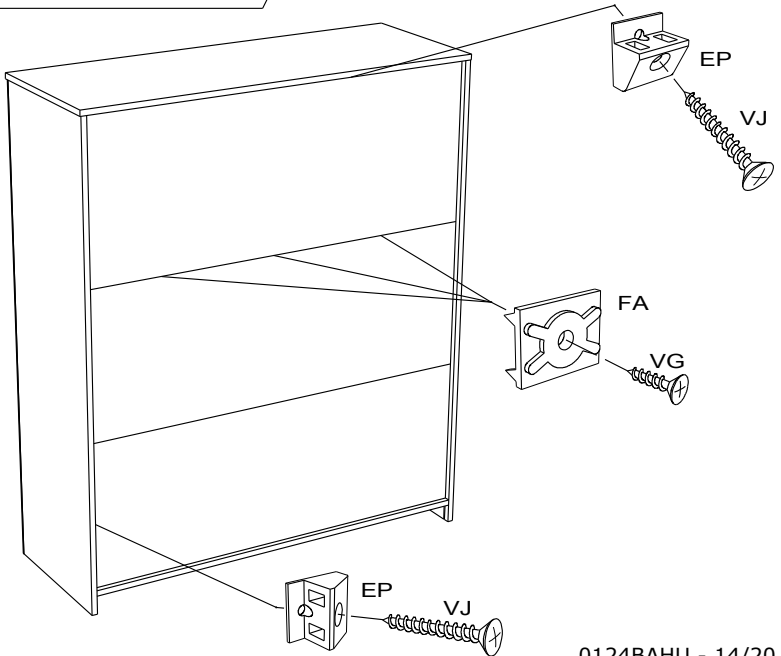

19



VG x 3

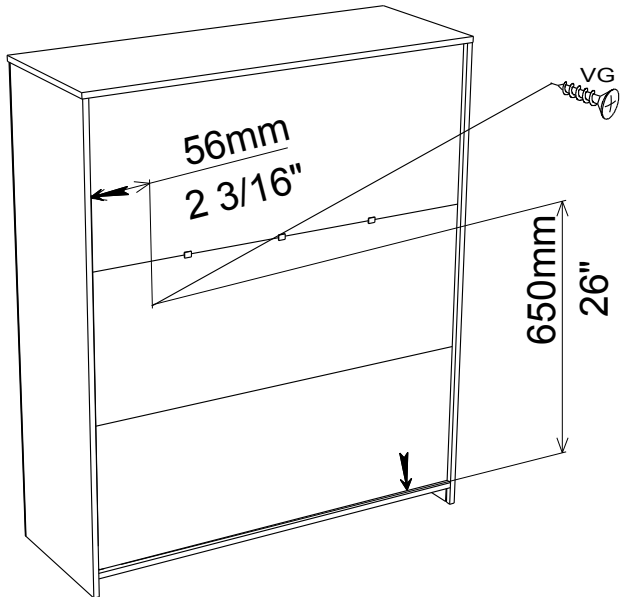
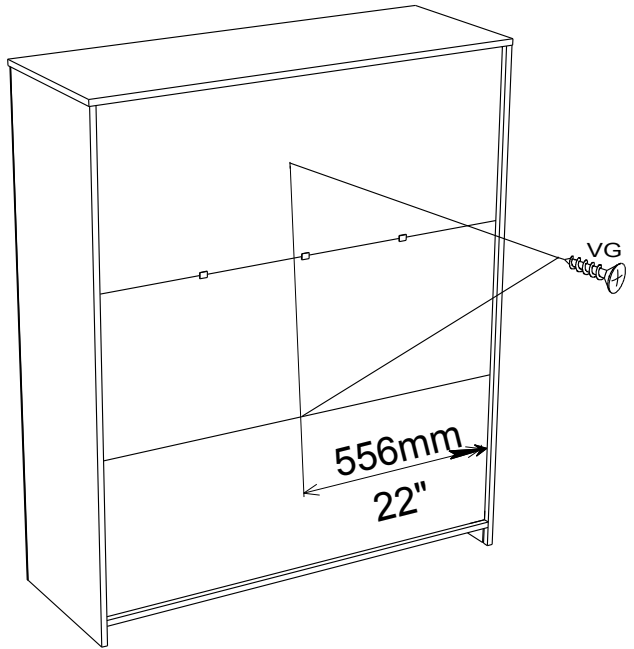

20

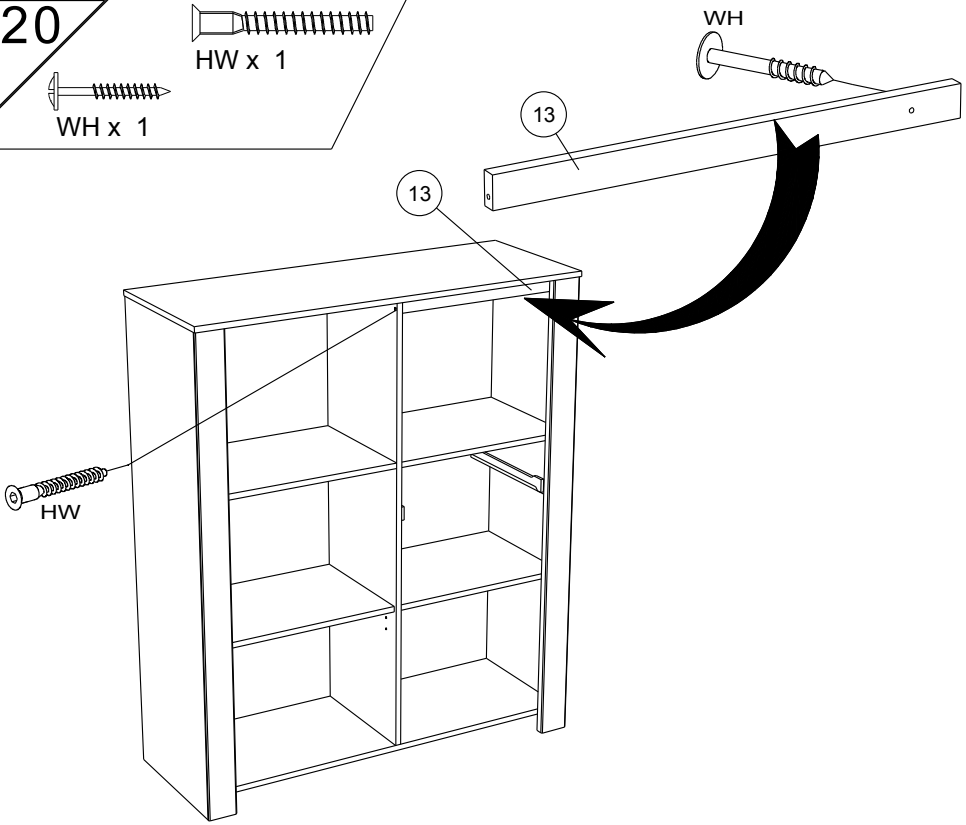
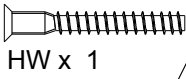
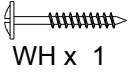

21

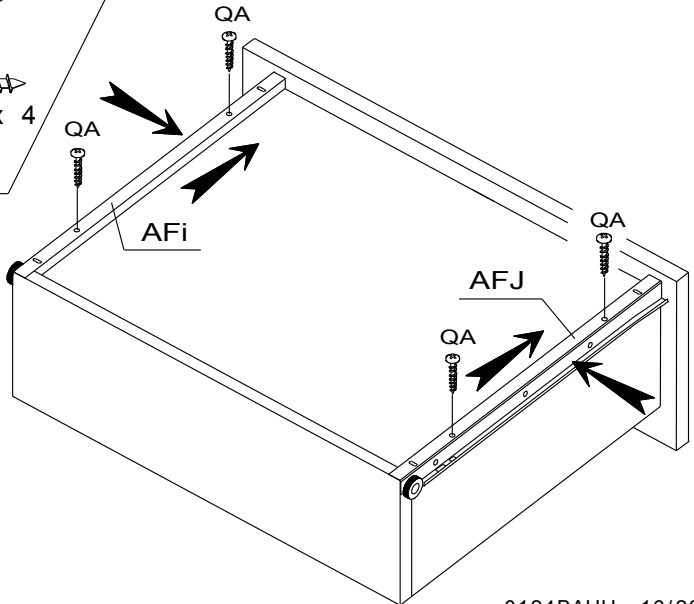
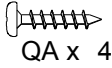



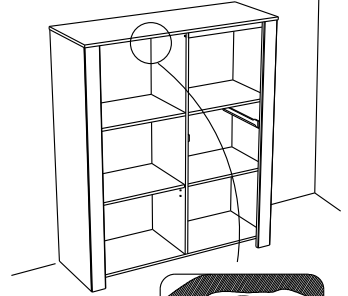

- FR** Pour votre sécurité : Fixation du meuble au mur  
Attention, la fixation doit être réalisée par une personne compétente car cela nécessite des chevilles adaptées à la nature de votre mur.
- EN** For your safety: the unit should be secured to the wall.  
NB this should be carried out by a competent person as you must use the right rawlplug for your type of wall.
- DE** Zu Ihrer Sicherheit: Befestigen Sie das Hochbett an der Wand.  
Achtung: Diese Befestigung ist durch eine fachlich kompetente Person vorzunehmen. Hierfür sind für die Bauweise Ihrer Wand geeignete Dübel einzusetzen.
- ES** Por su seguridad: Fijar el mueble a la pared.  
Advertencia: la fijación la ha de llevar a cabo por personal adecuado, ya que requiere el uso de tacos que se adapten al tipo de pared.
- PT** Para sua segurança: fixação do móvel ao muro  
Atenção: a fixação deverá ser efetuada por pessoa habilitada, visto que são necessárias cavilhas adaptadas ao tipo de parede.
- IT** Avvertenza di sicurezza: il fissaggio del mobile a parete deve essere realizzato da una persona competente, in quanto l'operazione richiede l'impiego di tasselli adatti alla natura del muro.
- NL** Voor uw veiligheid: bevestiging van het meubel aan de muur.  
Opgelet de bevestiging moet worden uitgevoerd door een bekwame persoon daar dit voor uw type muur geschikte pluggen vereist.
- CZ** Z bezpečnostních důvodů: upevněte nábytek do zdi  
Pozor, upevnění je třeba svěřit kompetentní osobě, neboť vyžaduje hmoždinky vhodné pro vaši zeď.
- HU** Az Ön biztonsága érdekében : a bútor falra rögzítése  
Figyelmeztetés : a rögzítés csak megfelelő szakképesítéssel rendelkező személy által végezhető el, mert a rögzítéshez a falnak megfelelő csavarokra van szükség.
- PL** Dla bezpieczeństwa: mocowanie mebla do ściany  
Uwaga, mocowanie musi zostać wykonane przez osobę kompetentną, ponieważ wymaga to zastosowania kołków dostosowanych do rodzaju ściany.
- RO** Pentru securitatea dumneavoastră: fixarea mobilierului de perete  
Atenție, fixarea trebuie să fie realizată de o persoană calificată, deoarece sunt necesare dispozitive de fixare adaptate caracteristicilor peretelui dumneavoastră
- RU** Для вашей безопасности: Крепление мебели к стене  
Внимание! Крепление должно производиться опытным специалистом, т.к. для такой установки потребуются шурупы, соответствующие типу вашей стены.
- SK** Z bezpečnostných dôvodov: nábytok upevnite k stene.  
Dbajte na to, aby upevnenie vykonala kompetentná osoba, pretože pri upevňovaní sa vyžadujú kolíky vhodné do materiálu, z ktorého je stena vyrobená.
- TR** Güvenliğiniz için: Mobilyanın duvara sabitlemesi  
Dikkat, sabitleme işlemi uzman biri tarafından yapılmalıdır çünkü bu işlem için duvarınızın malzemesine uygun dübellerin kullanılması gerekmektedir
- GR** Για την ασφάλειά σας : στερέωση των επίπλων στον τοίχο.  
Προσοχή, η στερέωση πρέπει να γίνεται από ικανό άτομο, καθώς απαιτούνται σφήignes προσαρμοσμένες στη φύση του τοίχου σας.

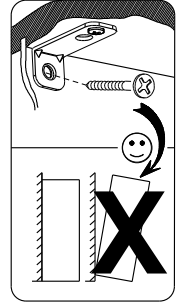

### اللغة العربية

لسلامتكم الشخصية: تثبيت قطعة الأثاث على الحائط  
تحذير، يجب أن يقوم شخص متخصص بعملية التثبيت على الحائط إذ أنها تتطلب اسفينا  
معينا يتوافق مع طبيعة الحائط نفسه.

23

BWD x 8

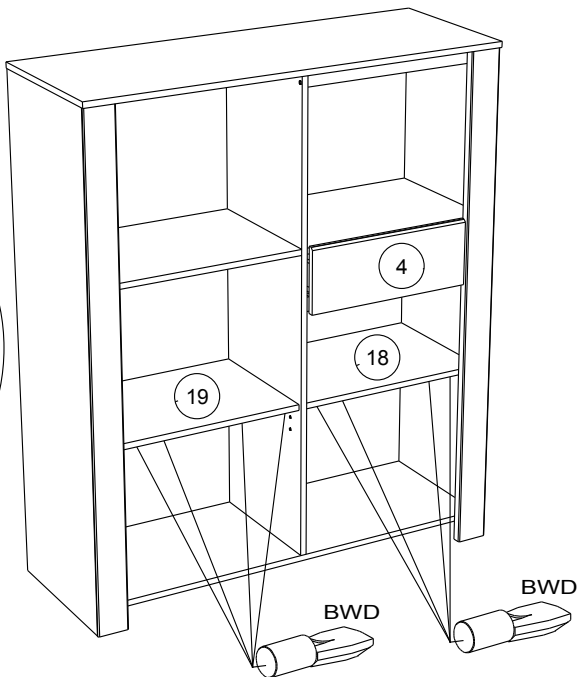
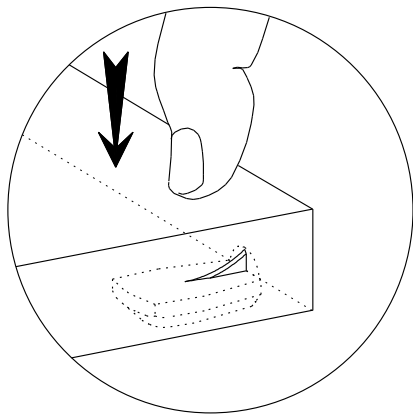

24

CCR x 4 BVS x 3

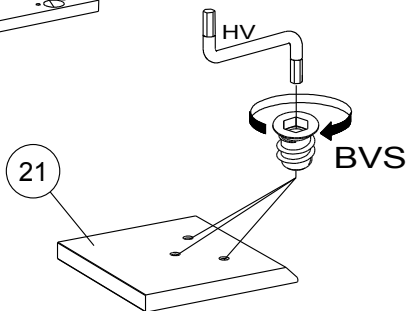
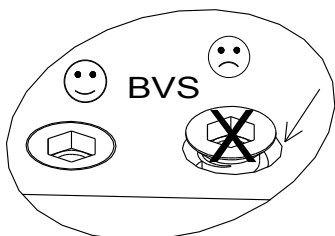
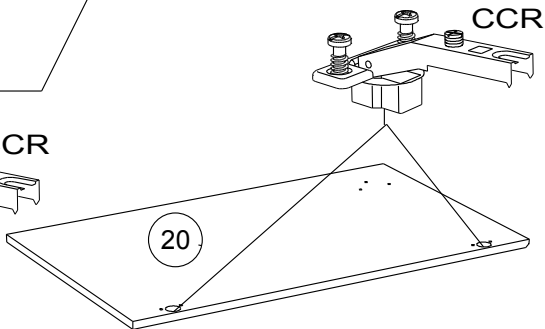
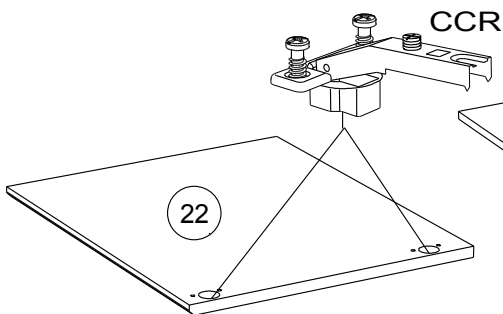

25



YM x 3



QP x 3

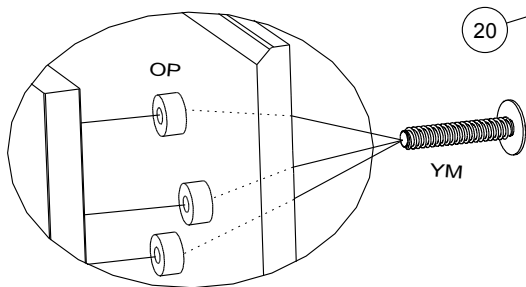
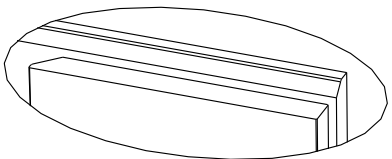

RCH-C-N

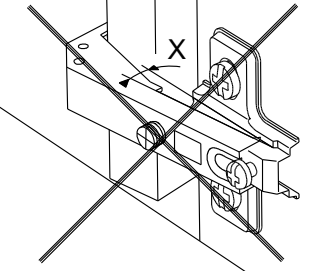

MONTAGE

- (GB) LEAFLET
- (D) AUFBAUANLEITUNG
- (E) MONTAGE
- (P) MONTAGEM
- (I) MONTAGGIO
- (NL) MONTAGE

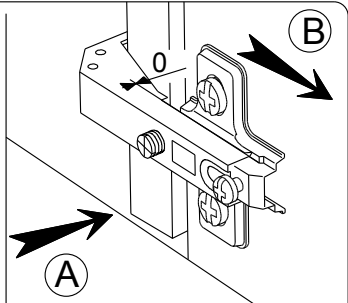

REGLEGE (GB) ADJUSTING (E) AJUSTER (I) AGGIUSTAMENTO (D) ANPASSUNG (P) REGULACAO (NL) AFSTELLING

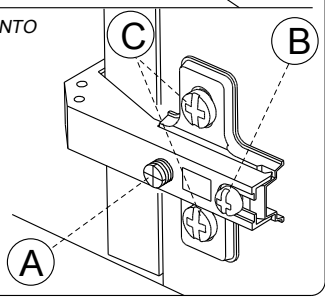
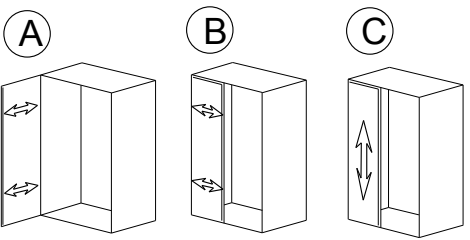

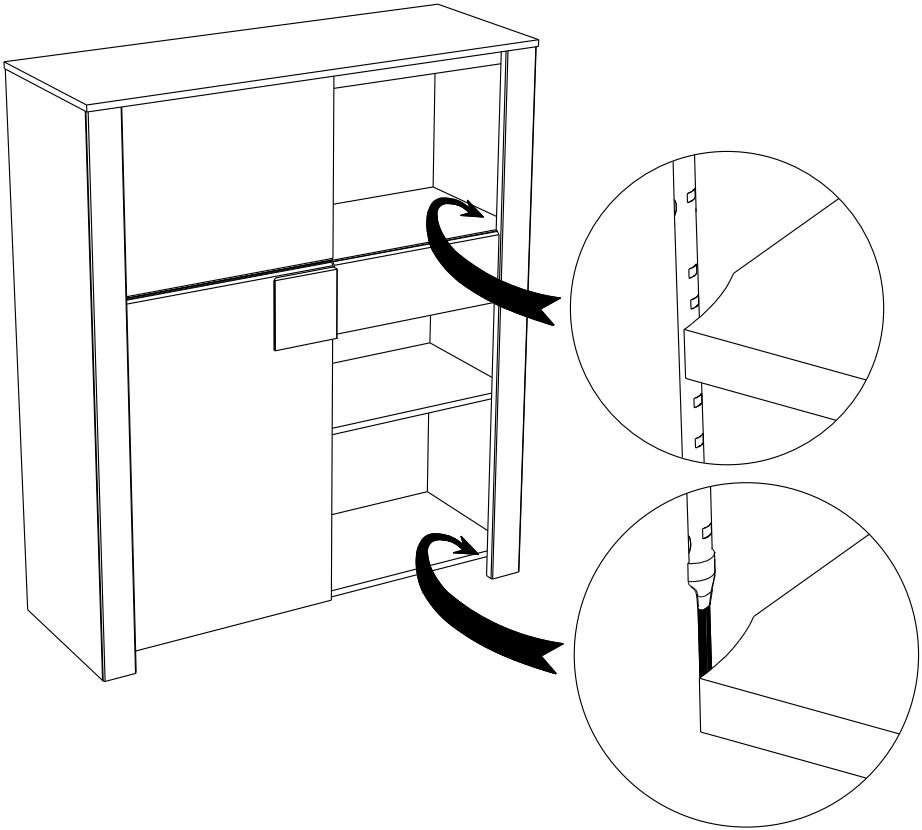

POSSIBILITE  
D'ECLAIRAGE PAR LEDS  
DISPONIBLE EN MAGASIN

