

**NOTICE
DE
MONTAGE**

(GB) INSTRUCTION LEAFLET: (E) NOTICIA DE MONTAJE:
(D) AUFBAUANLEITUNG: (P) INSTRUCOES DE MONTAGEM: (I) LIBRETTO DI MONTAGGIO:
(NL) MONTAGEHANDLEIDING:

2062CO3T

OUTILLAGES

(GB) TOOLS (D) HANDWERKZEUGE (E) HERRAMIENTAS (P) FERRAMENTAS (I) ATTREZZATURA (NL) GEREEDSCHAP

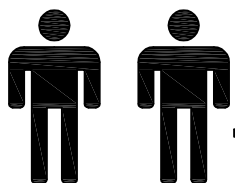

1
h

00
mn

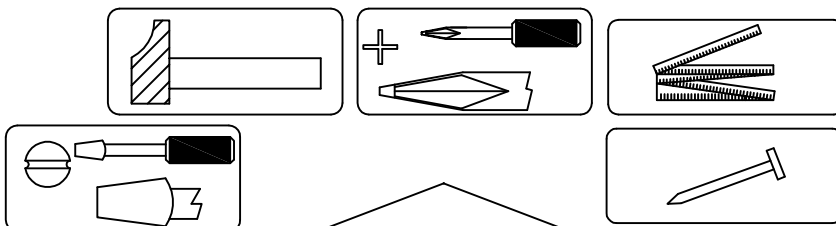

74 cm
29 1/4"
92 cm
36 1/4"
47 cm
18 1/2"

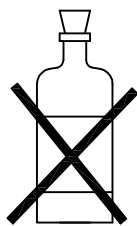
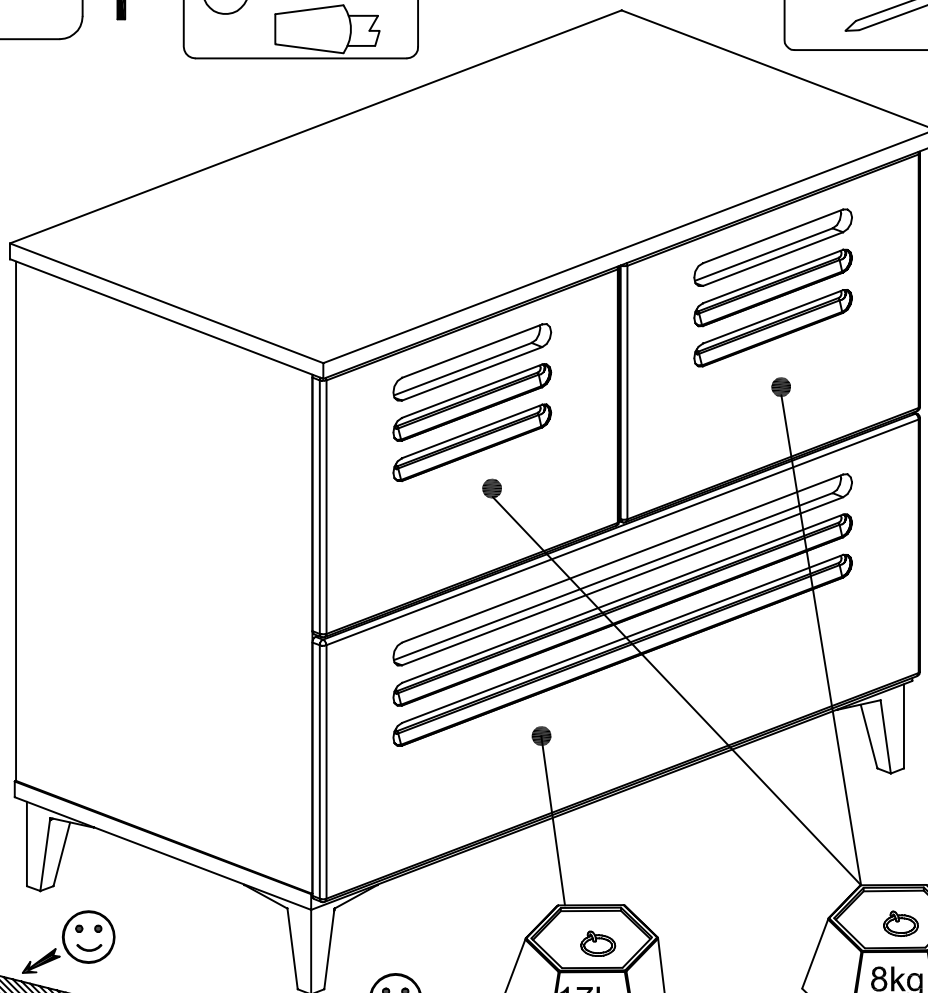

SOLVANT

- (GB) DILUANT
- (D) LOSUNGSMITTEL
- (E) DILUYENTE
- (P) DISSOLVENTE
- (I) SOLVENTE
- (NL) OPLOSMIDDEL

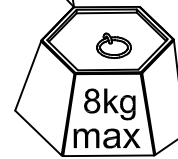
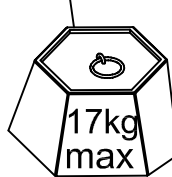
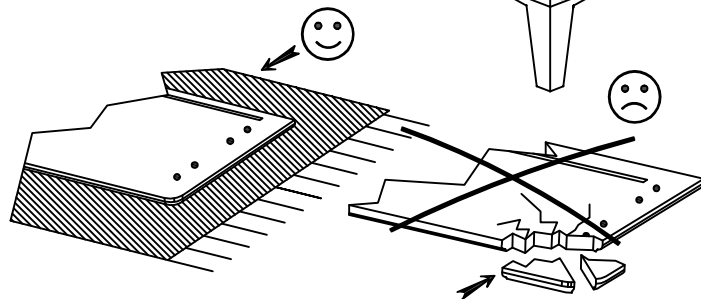

GARDEZ CE DOCUMENT :

POUR L'APRES-VENTE, RETOURNEZ AU MAGASIN AVEC CETTE NOTICE

- (GB) PLEASE NOTIFY THE RETAILER WHERE YOU PURCHASED IT FROM, QUOTING:THE REFERENCE OF FURNITURE AND OF THE COMPONENT.
- (D) WENDEN SIE SICH BITTE AN IHREN HANDLER UND GEBEN SIE IHM DIE KENNUMMER DES MOBELS UND DIE TEILNUMMER.
- (E) CONSERVAR ESTE DOCUMENTO:PARA EL SERVICIO POST VENTA, VUELVA A LA TIENDA CON ESTA NOTICIA.
- (P) GUARDAR ESTE DOCUMENTE : PARA DEPOIS DA VENDA, VOLTAR A LOJA COM ESTAS INSTRUCOES.
- (I) CONSERVARE QUESTO DOCUMENTO:PER OGNI RICHIESTA DOPO ACQUISTO, TORNARE AL NEGOZIO CON QUESTO LIBRETTO.
- (NL) BEWAAR DEZE HANDLEIDING GOED. IN GEVAL VAN PROBLEMEN OF EVENTUELE KLACHTEN NEEM DAN DEZE HANDLEIDING, MEE NAAR DE WINKEL WAAR U DE KAST HEEFT GEKOCHT

REPEREZ LES PIECES SUR LA "VUE ECLATEE"

- Ⓒ LOCATE THE PIECES ON THE "CROSS SECTION"
- Ⓓ IDENTIFIZIEREN SIE DIE TEILE AN HAND DER "PERSPEKTIVISCHEN DARSTELLUNG"
- Ⓔ LOCALIZACION DE LAS PIEZAS
- Ⓟ ENCONTRAR AS PECAS NA "VISTA REBINTADA"
- Ⓡ INDIVIDUARE OGNI PEZZO SULLA "VUE ECLATEE"
- Ⓝ PLAATS DE STUKKEN VOLGENS HUN "LOSSE OBSTELLING"

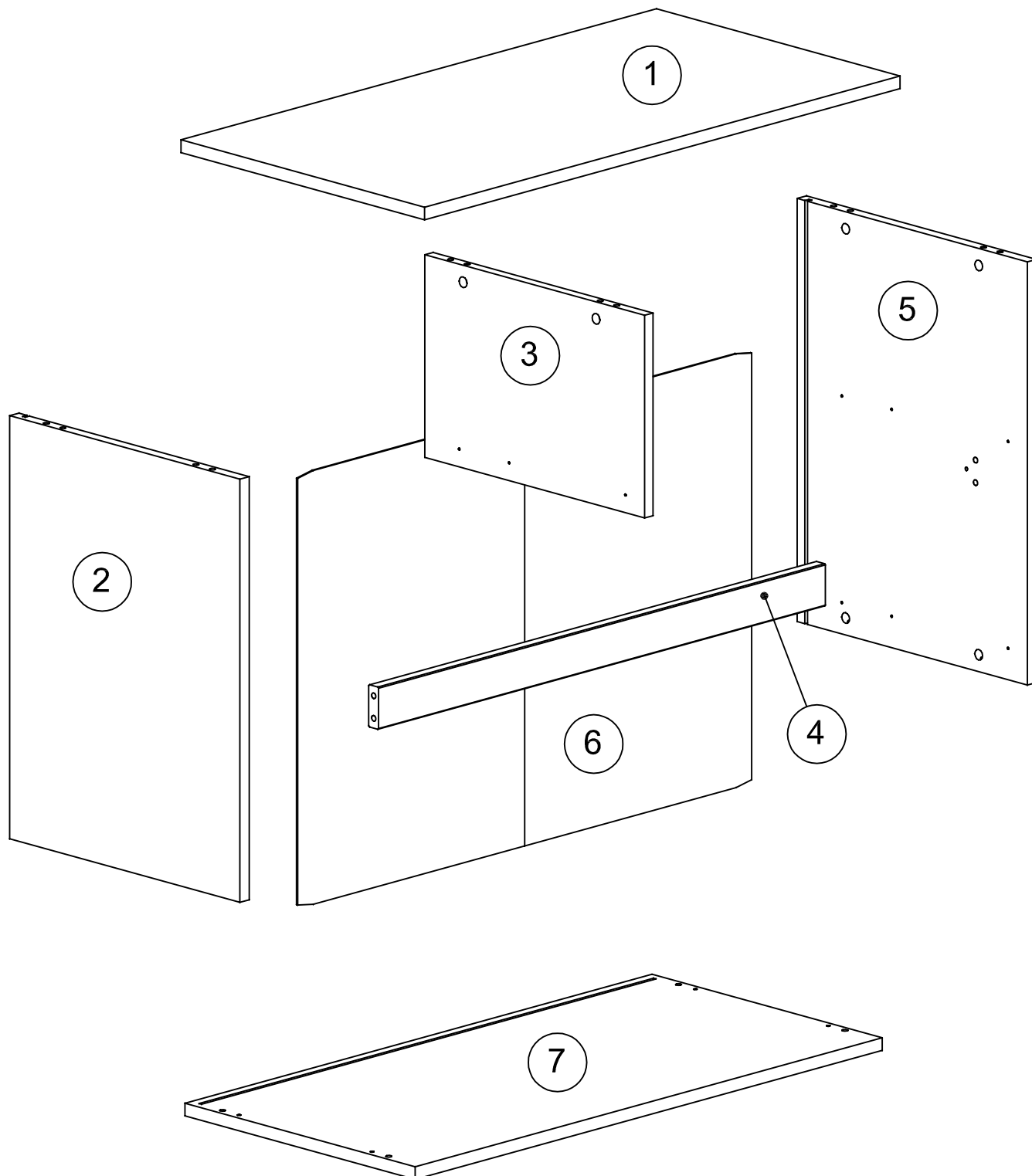

REPEREZ LES PIECES SUR LA "VUE ECLATEE"

Ⓒ LOCATE THE PIECES ON THE "CROSS SECTION"

Ⓓ IDENTIFIZIEREN SIE DIE TEILE AN HAND DER "PERSPEKTIVISCHEN DARSTELLUNG"

Ⓔ LOCALIZACION DE LAS PIEZAS

Ⓕ ENCONTRAR AS PECAS NA "VISTA REBINTADA"

Ⓖ INDIVIDUARE OGNI PEZZO SULLA "VUE ECLATEE"

Ⓝ PLAATS DE STUKKEN VOLGENS HUN "LOSSE OBSTELLING"

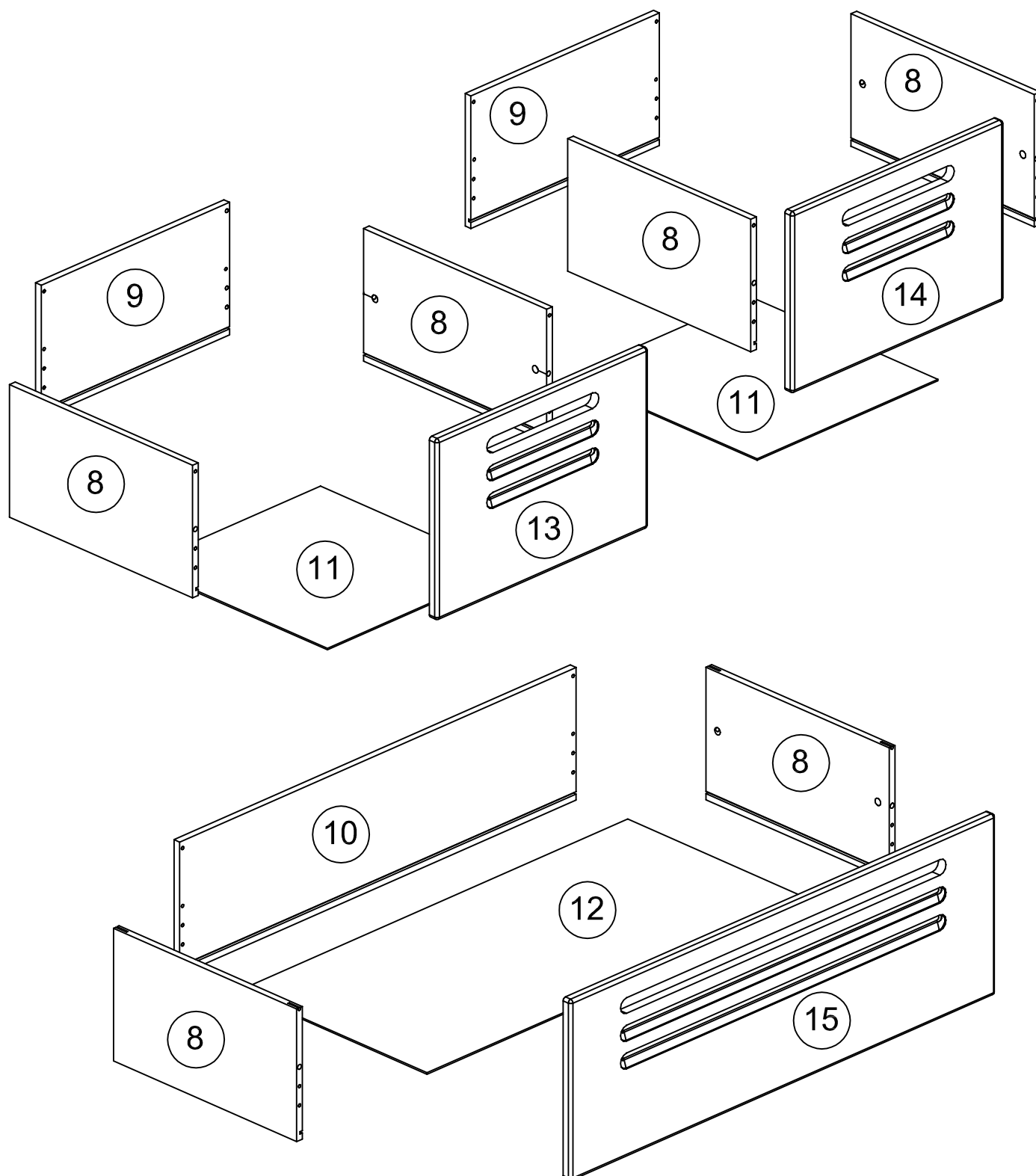

LISTE QUINCAILLERIE

- Ⓒ LIST OF COMPONENTS
- Ⓓ BESCHLAGE
- Ⓔ LISTA DE HERRAJES
- Ⓕ LISTA DE FERRAGENS
- Ⓖ LISTA CHINCAGLIERIA
- Ⓗ LIJST VAN TOEBEHOREN

REPERE DE LA QUINCAILLERIE
 COMPONENT REFERENCE NUMBER
 TEIL REFERENZ
 CODIFICACION DE LOS HERRAJES
 REFERENCIA DA FERRAGENS
 RIFERIMENTO DELLA CHINCAGLIERIA
 CONTROLE VAN HET TOEBEHOREN

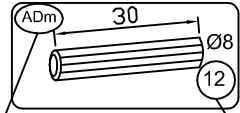

QUANTITE UTILISEE
 NUMBER OF PIECES
 GEBRAUCHTE MENGE
 CANTIDAD UTILIZADA
 QUANTIDADE UTILISADA
 QUANTITA UTILIZZATA
 GEBRUIKTE HOEVEELHEID

ADm 30 Ø8 14	ADU 30 Ø5 36	AD 24 22	Ai 10	ZBJ 12	FA 2	EP 14
VI 3.5 X 15 36	WJ 3.5 X 20 16	VJ 3.5 X 25 17	BLL 3	VB 6.5x12.5 5		
AFM L = 400 3	AFN L = 400 3	AFK L = 400 3	AFL L = 400 3			
ZPF 4	BLM 1	CF COLLE COLA GLUE COLLA LEIM LIJM COLA 1				

PHASE

1

ADU 30 Ø5 36	ZBJ 12	CF COLLE COLA GLUE COLLA LEIM LIJM COLA 1
-----------------------	-----------	--

REMUER AVANT EMPLOI

6 PIECES

- Ⓒ 6 PARTS
- Ⓓ 6 STUCKEN
- Ⓔ 6 PIEZAS
- Ⓕ 6 PECAS
- Ⓖ 6 PEZZI
- Ⓗ 6 STUKS

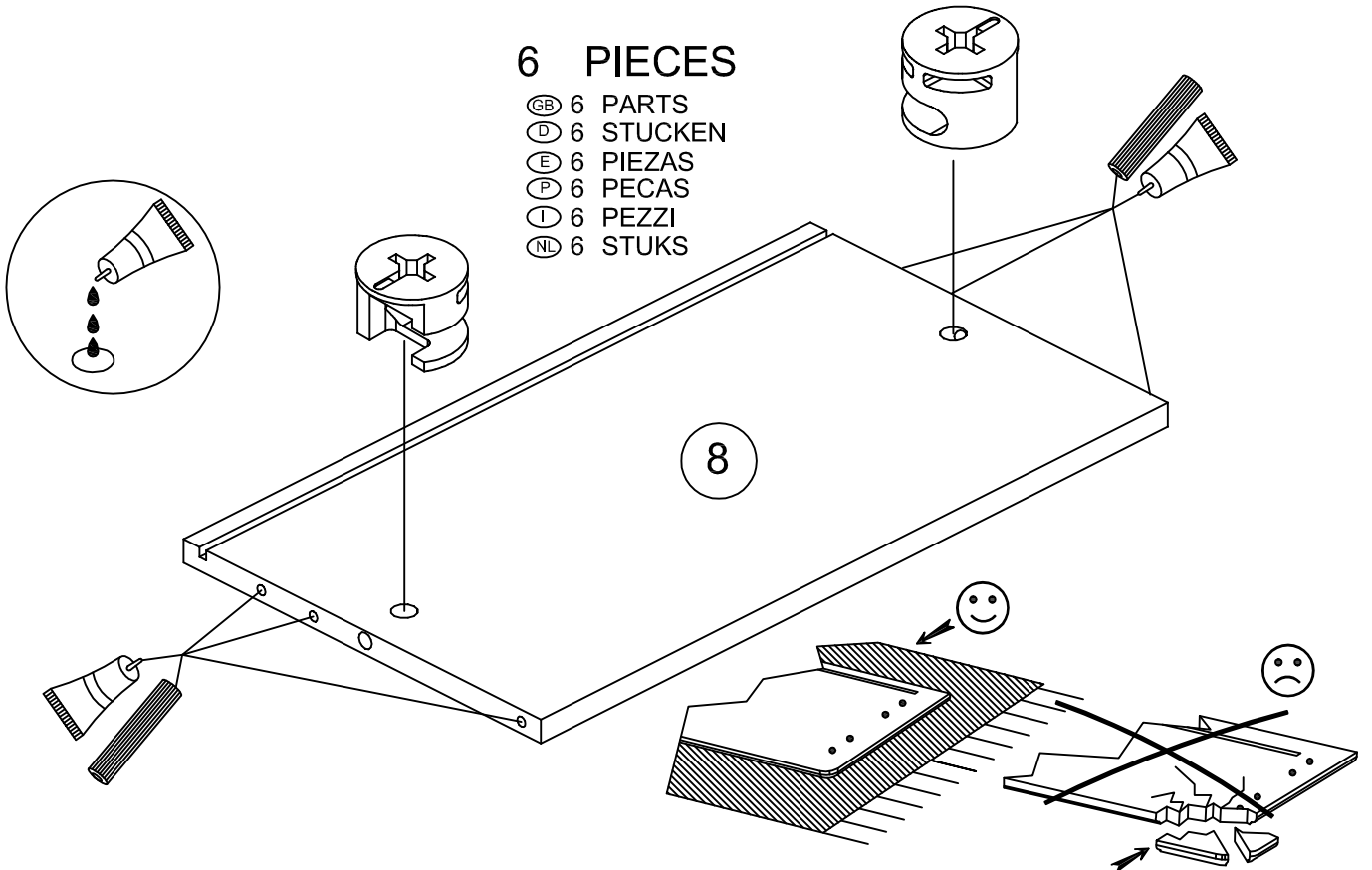

PHASE

2

AD

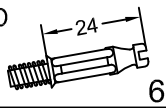

2 PIECES

- GB 2 PARTS
- D 2 STÜCKEN
- E 2 PIEZAS
- P 2 PECAS
- I 2 PEZZI
- NL 2 STUKS

CF

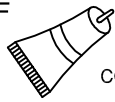

COLLE COLA
GLUE COLLA
LEIM LIJM
COLA

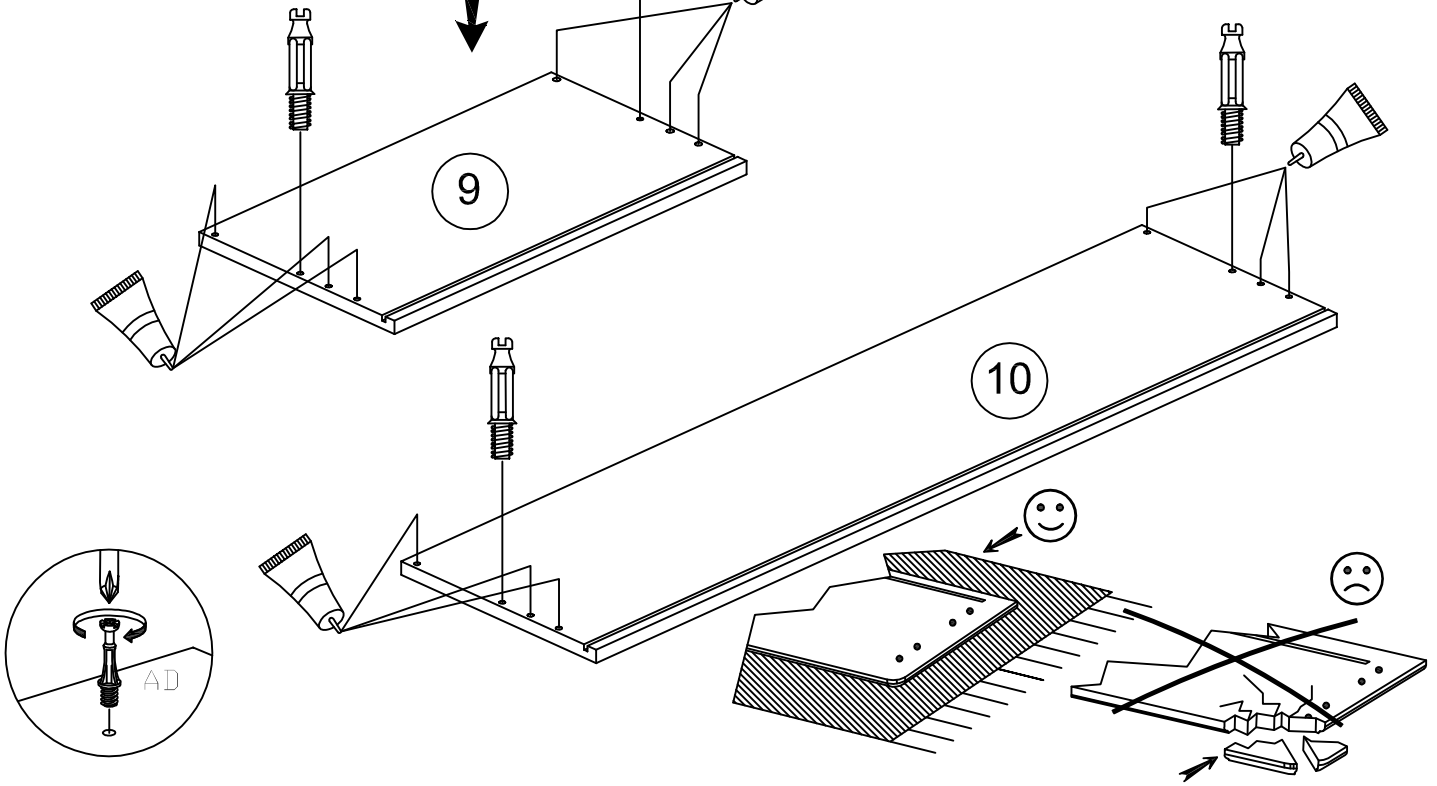
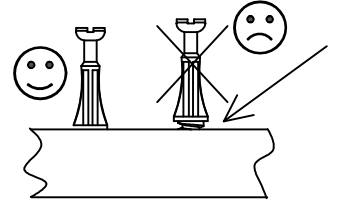
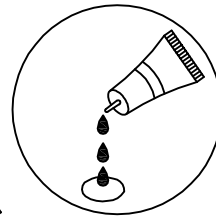

PHASE

3

AD

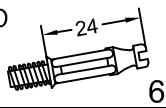

CF

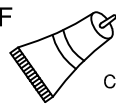

COLLE COLA
GLUE COLLA
LEIM LIJM
COLA

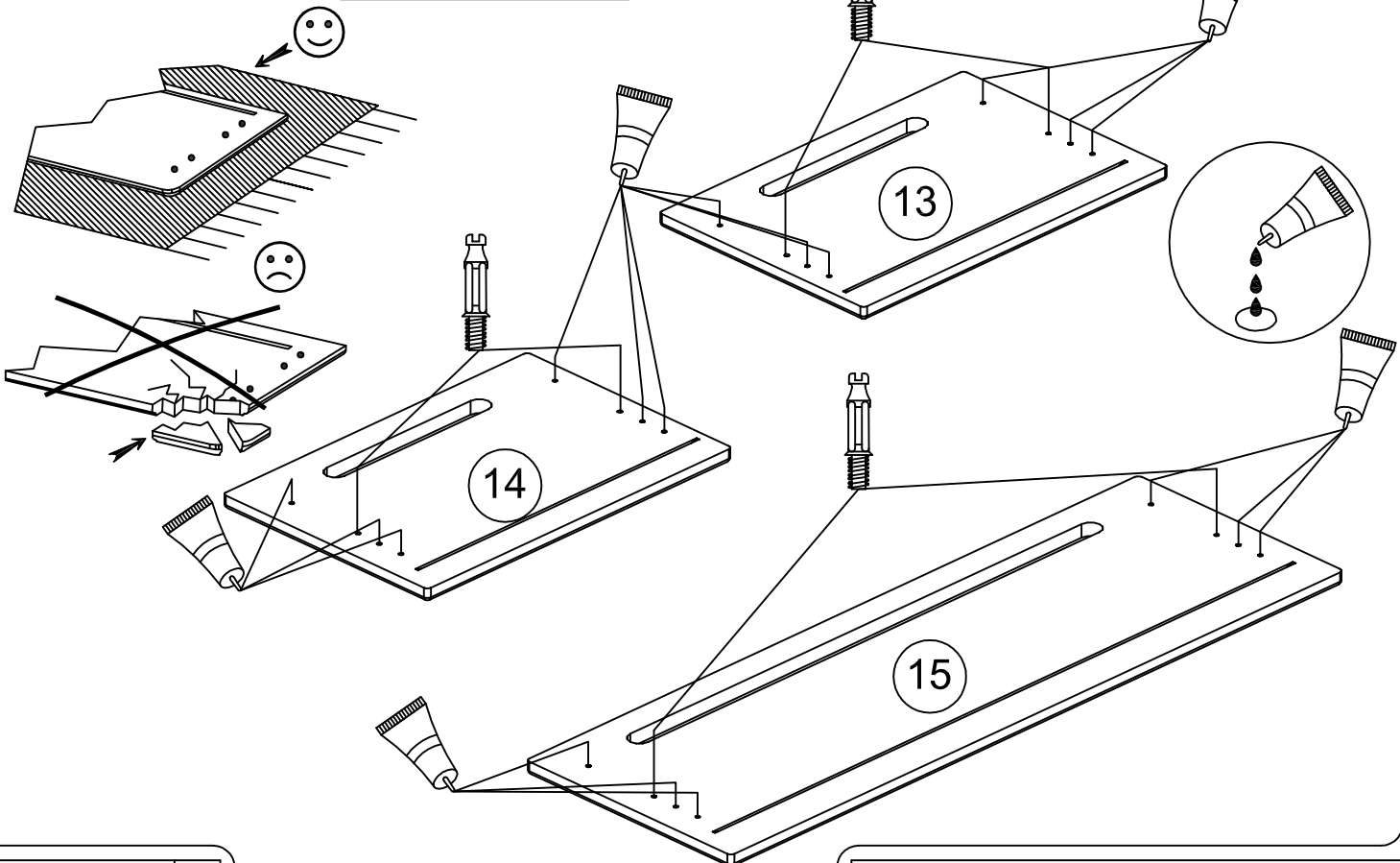

PHASE

4

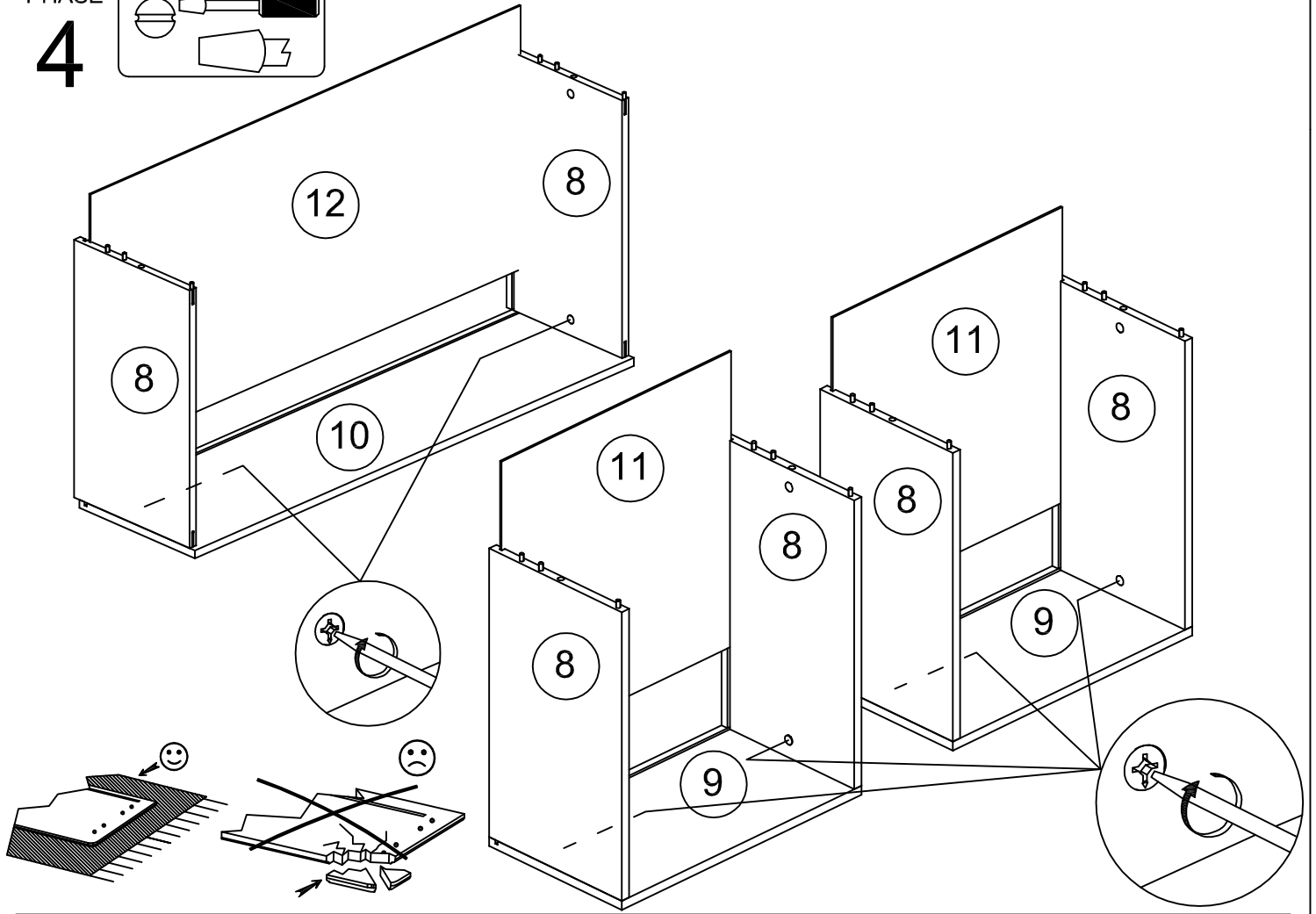
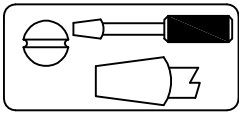

PHASE

5

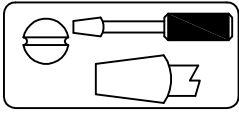

24,5mm

36,5mm

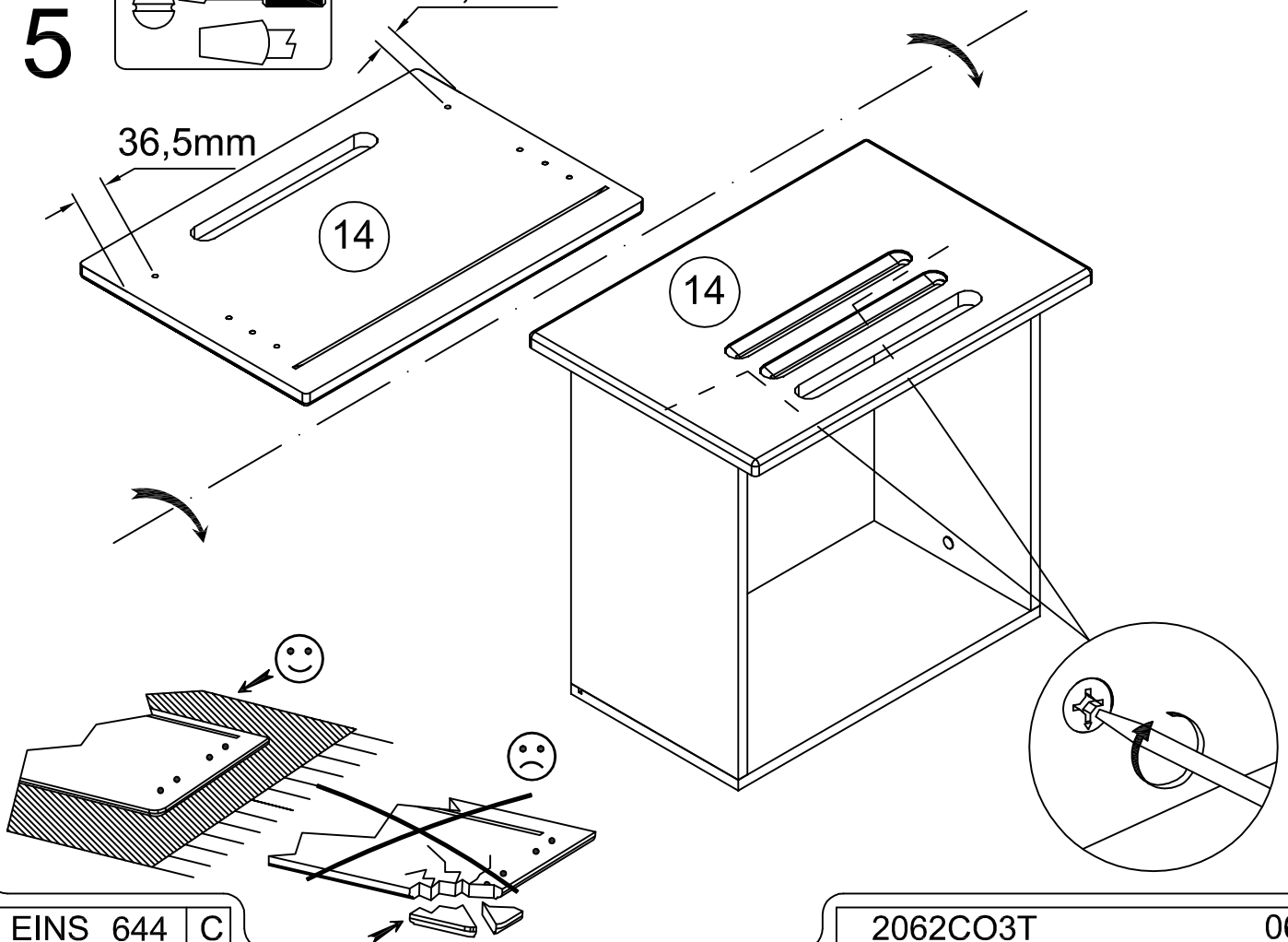

PHASE

6

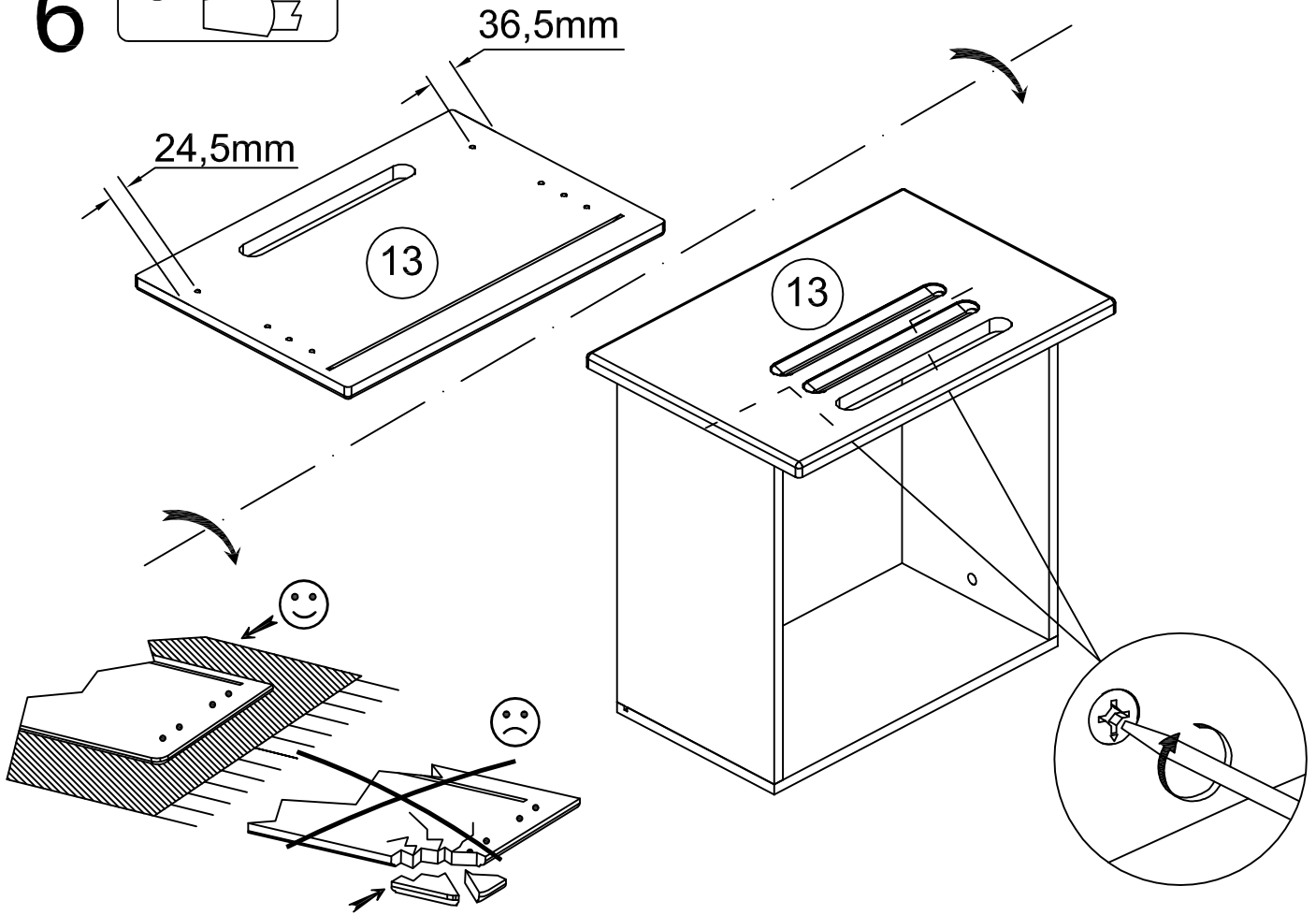
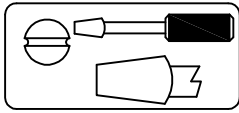

PHASE

7

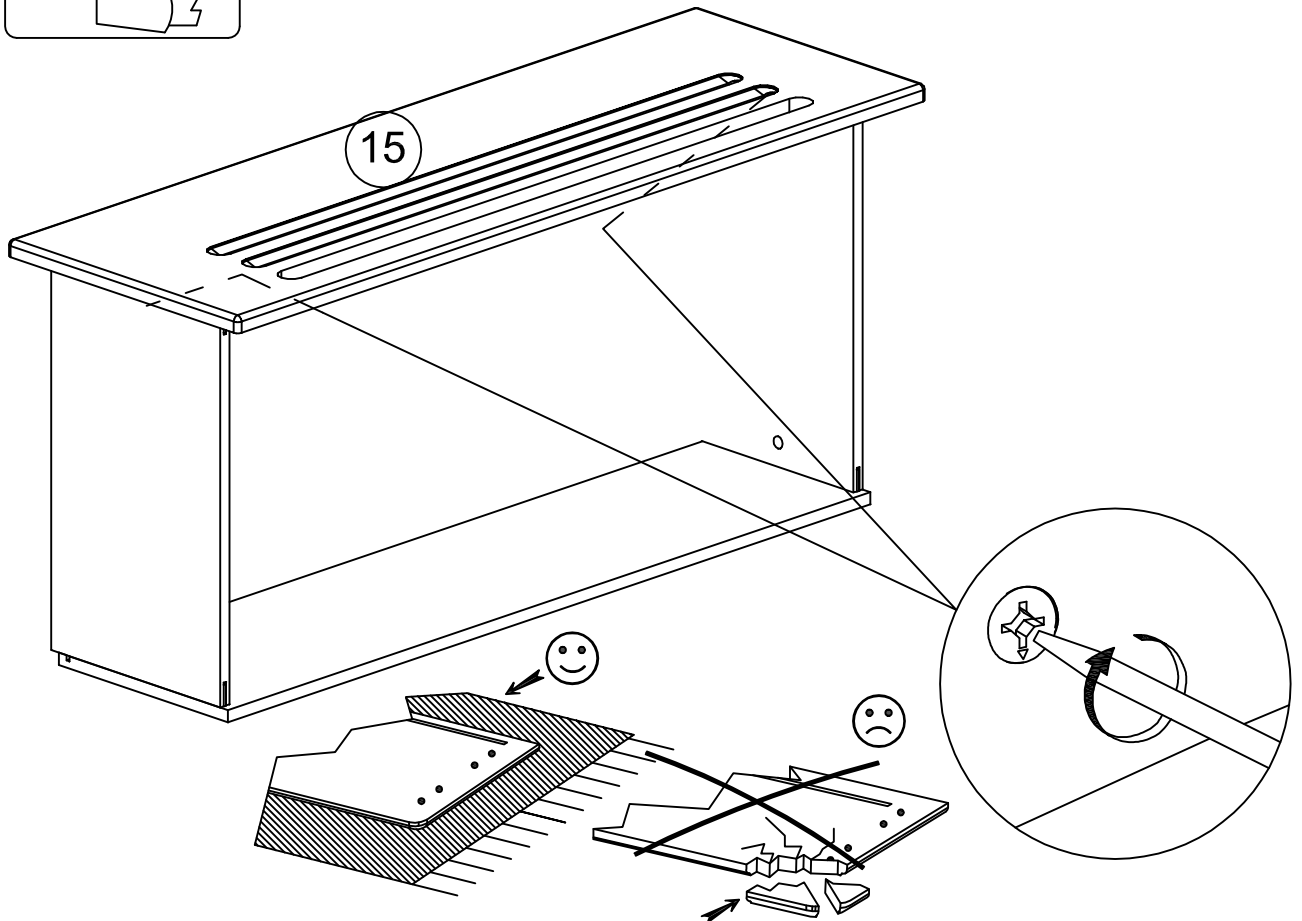
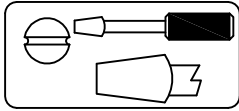

PHASE

8

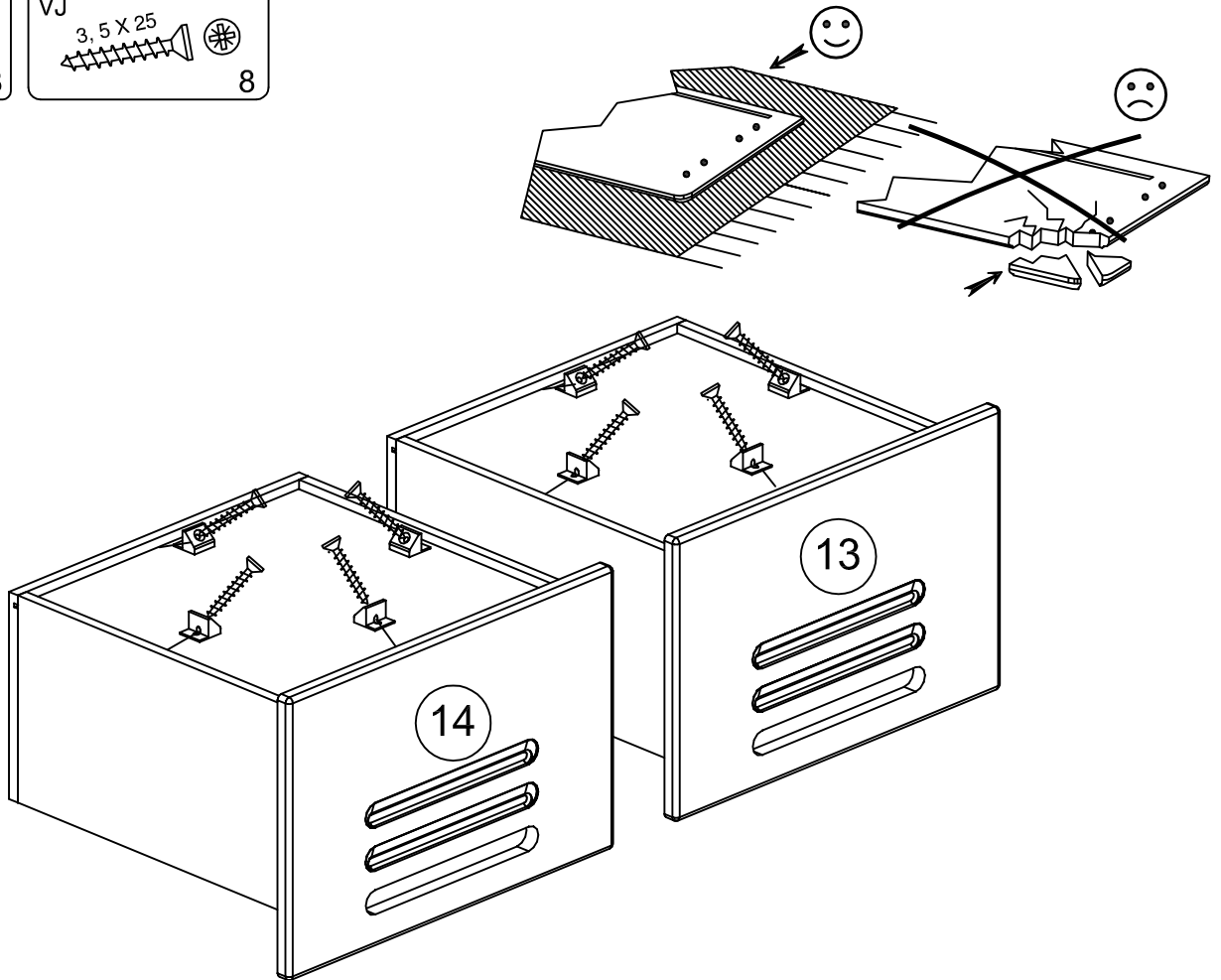
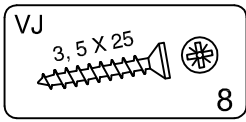

PHASE

9

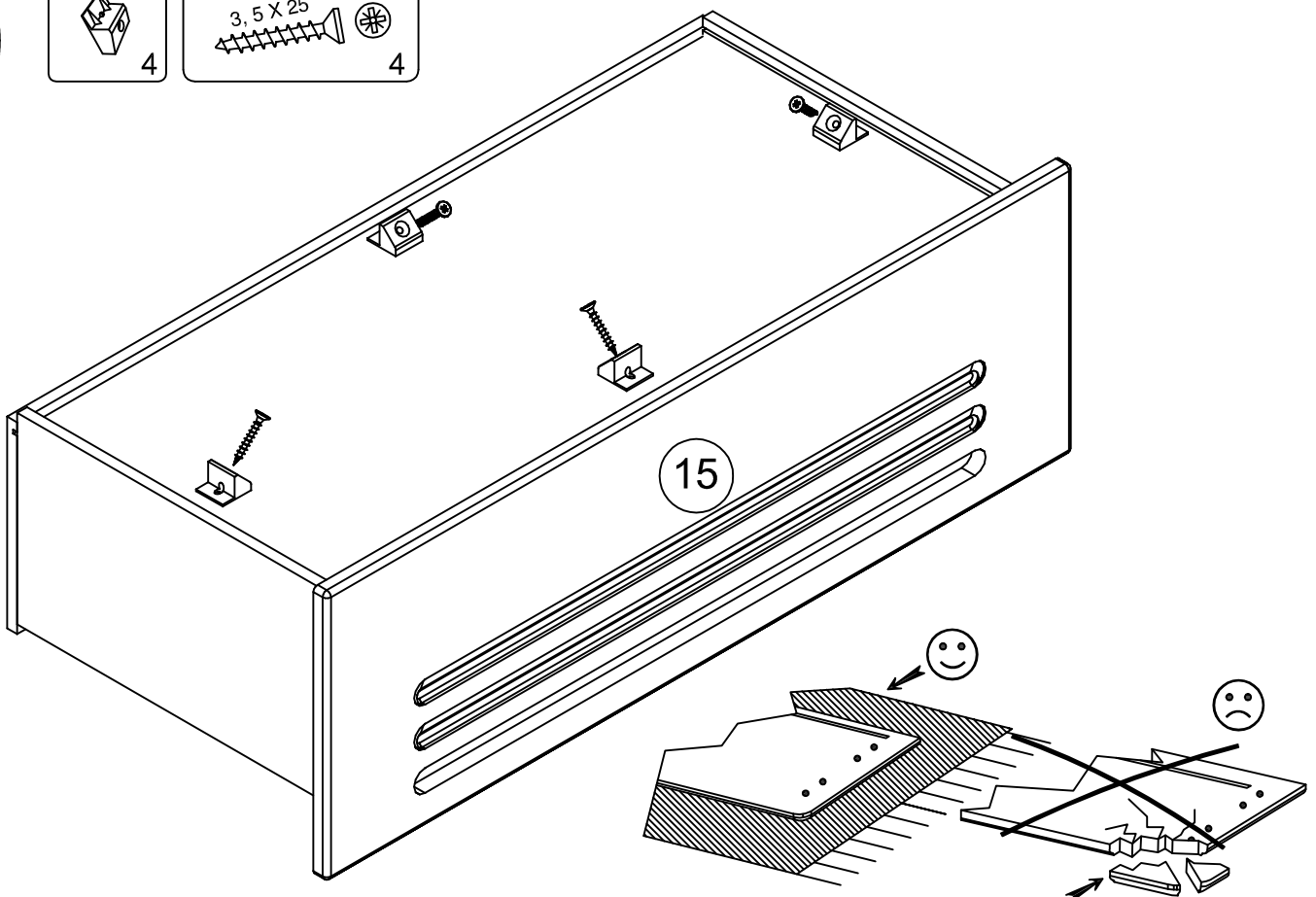
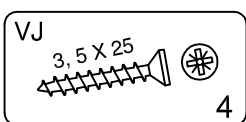

PHASE

10

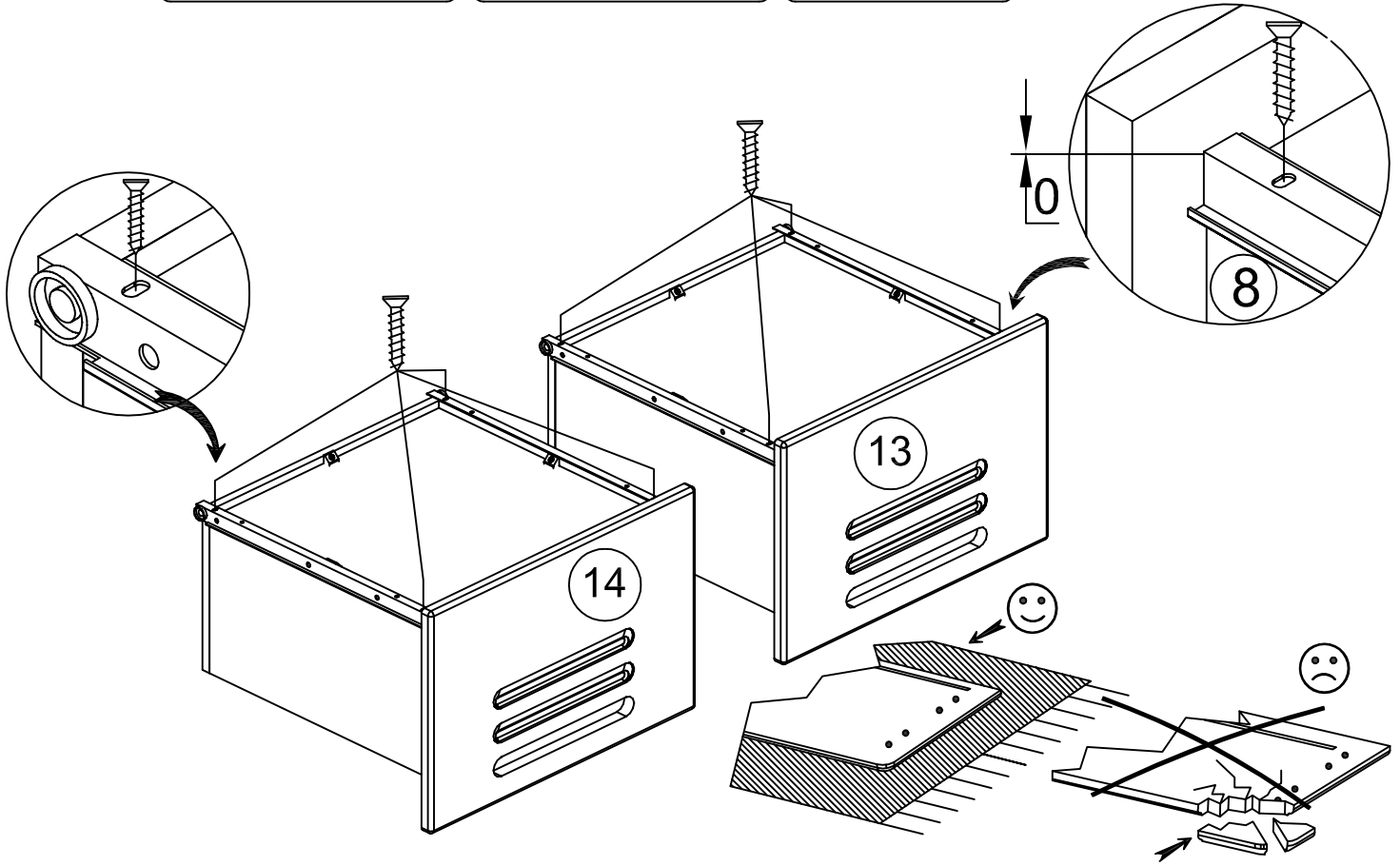
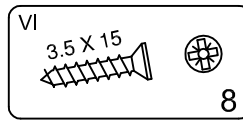
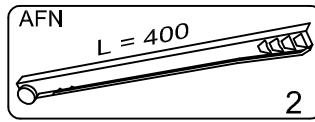
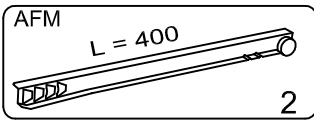

PHASE

11

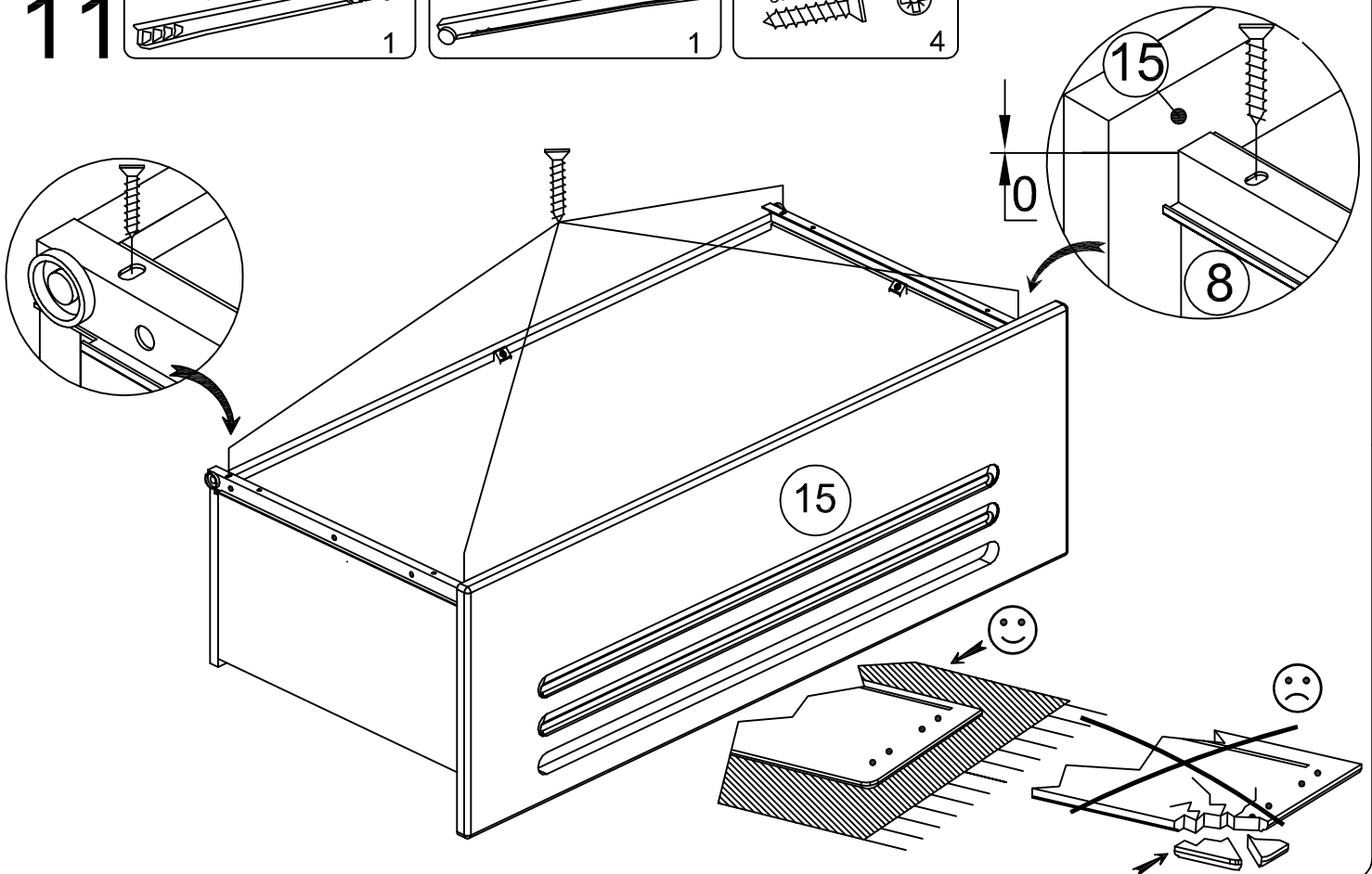
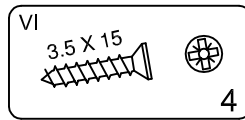
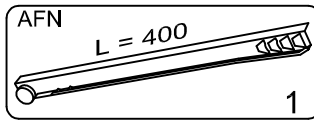
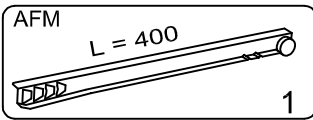

PHASE

12

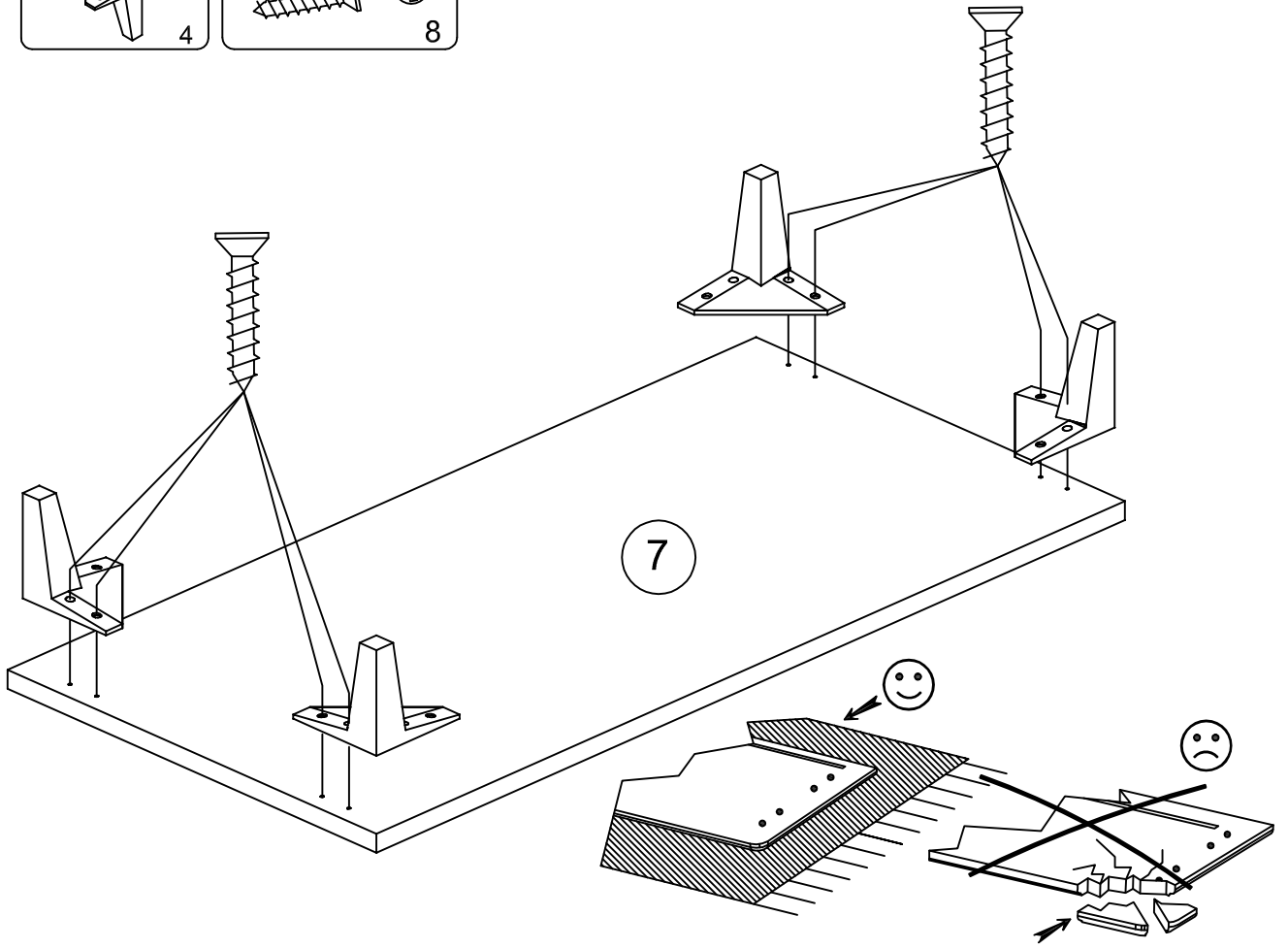
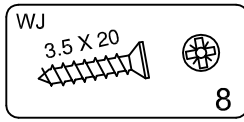
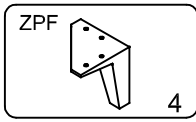

PHASE

13

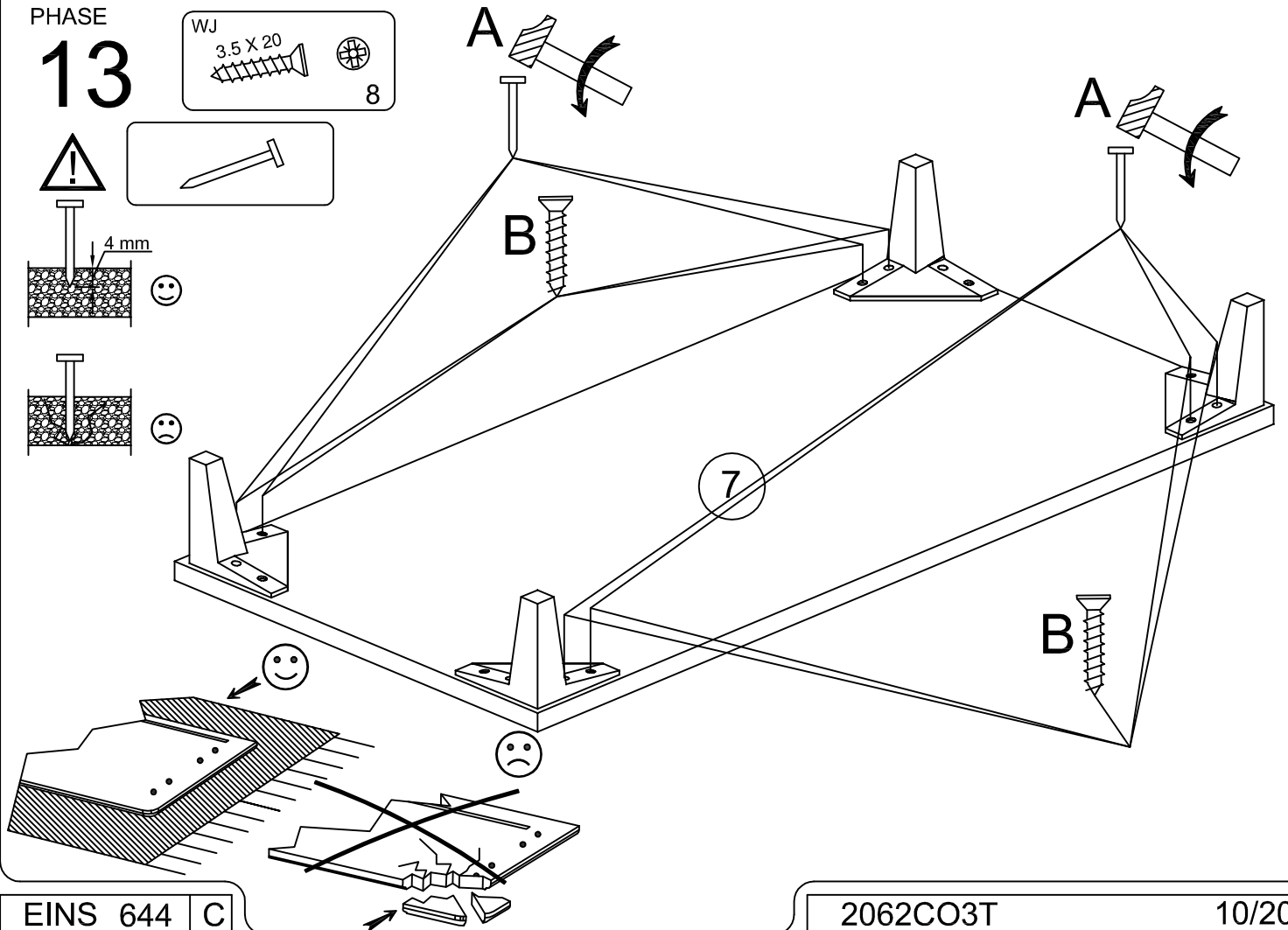
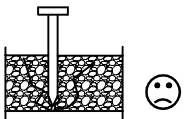
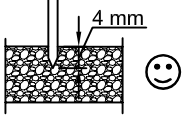
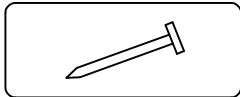
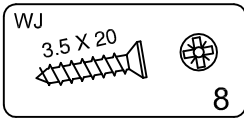

PHASE

14

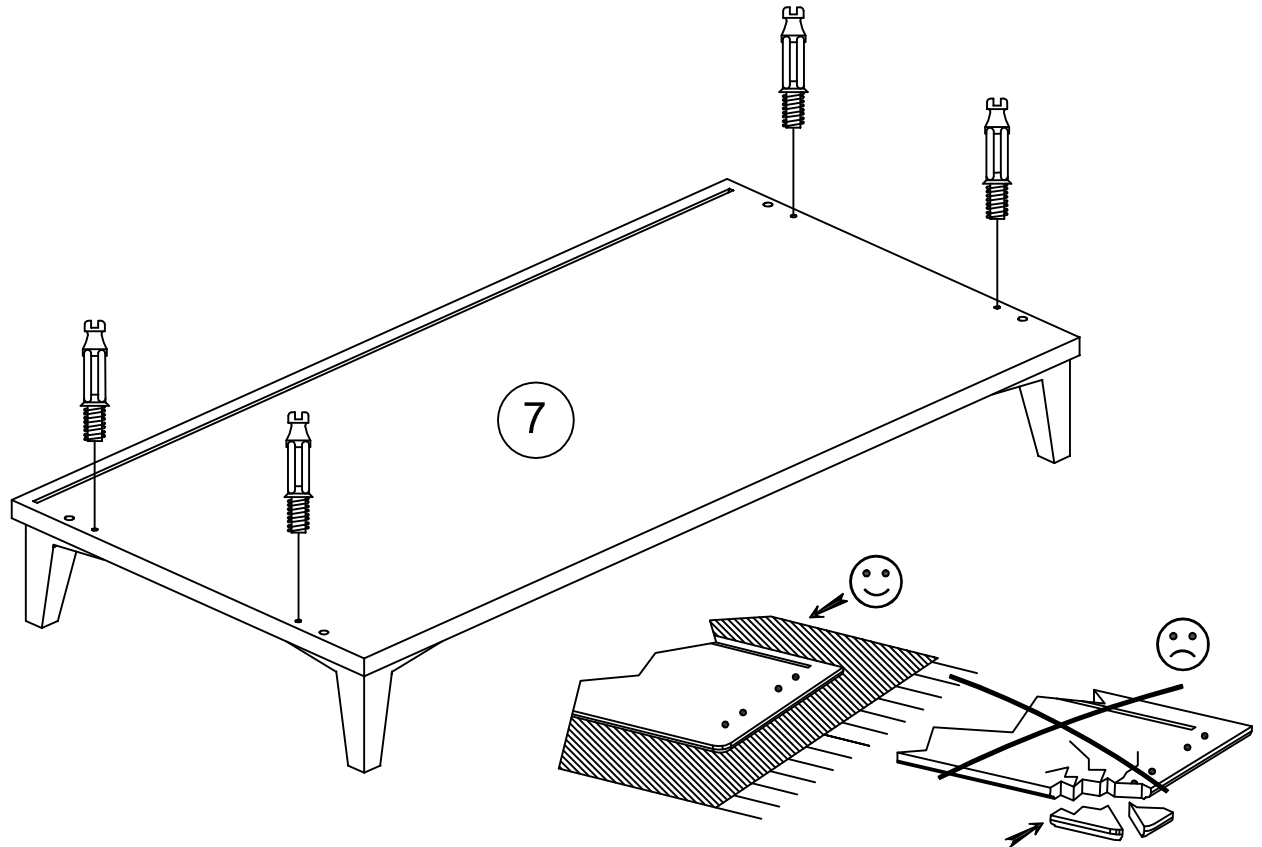
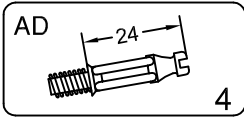

PHASE

15

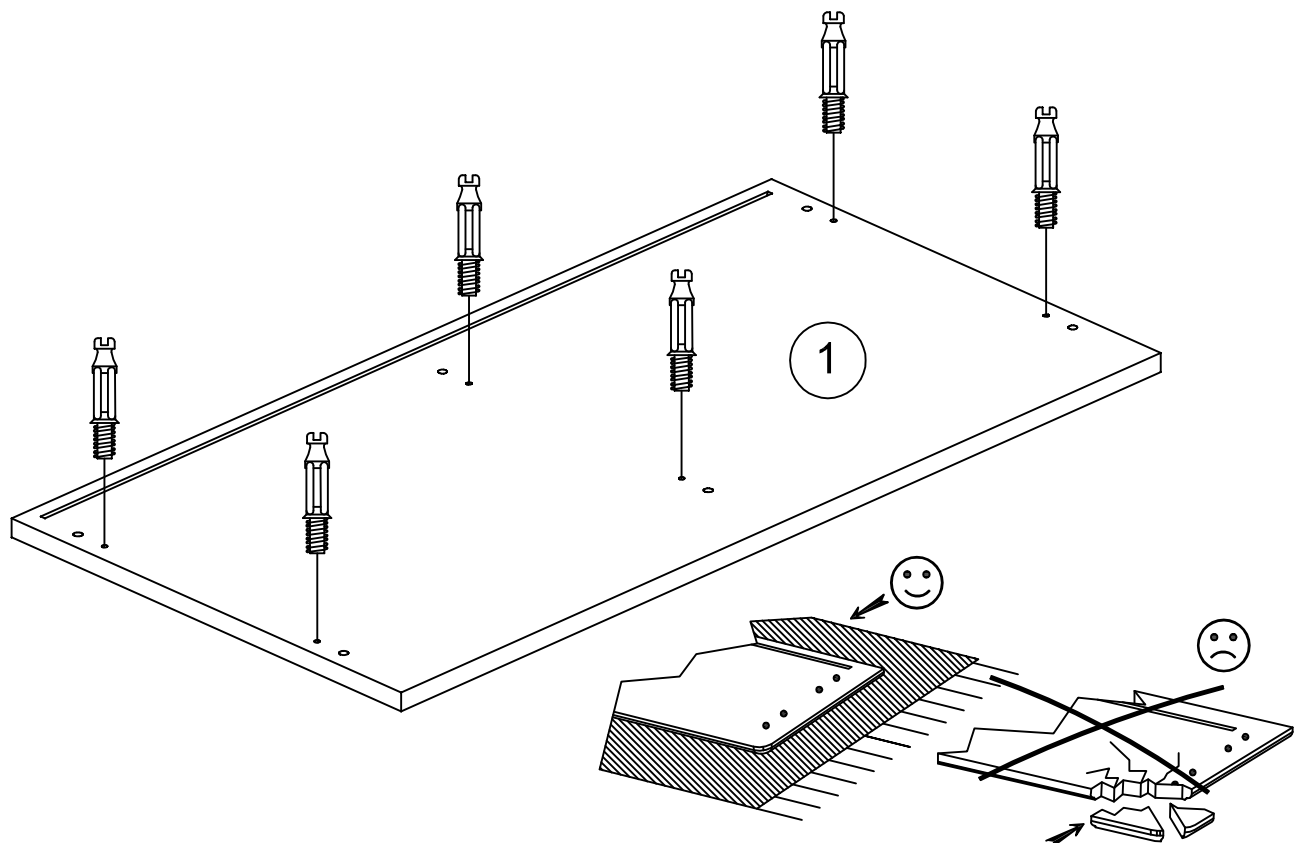
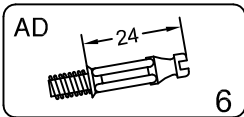

PHASE

16

AFK

L = 400

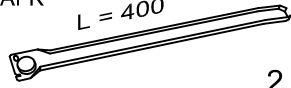

2

VI

3.5 X 15



8

ADm

30

Ø8



4

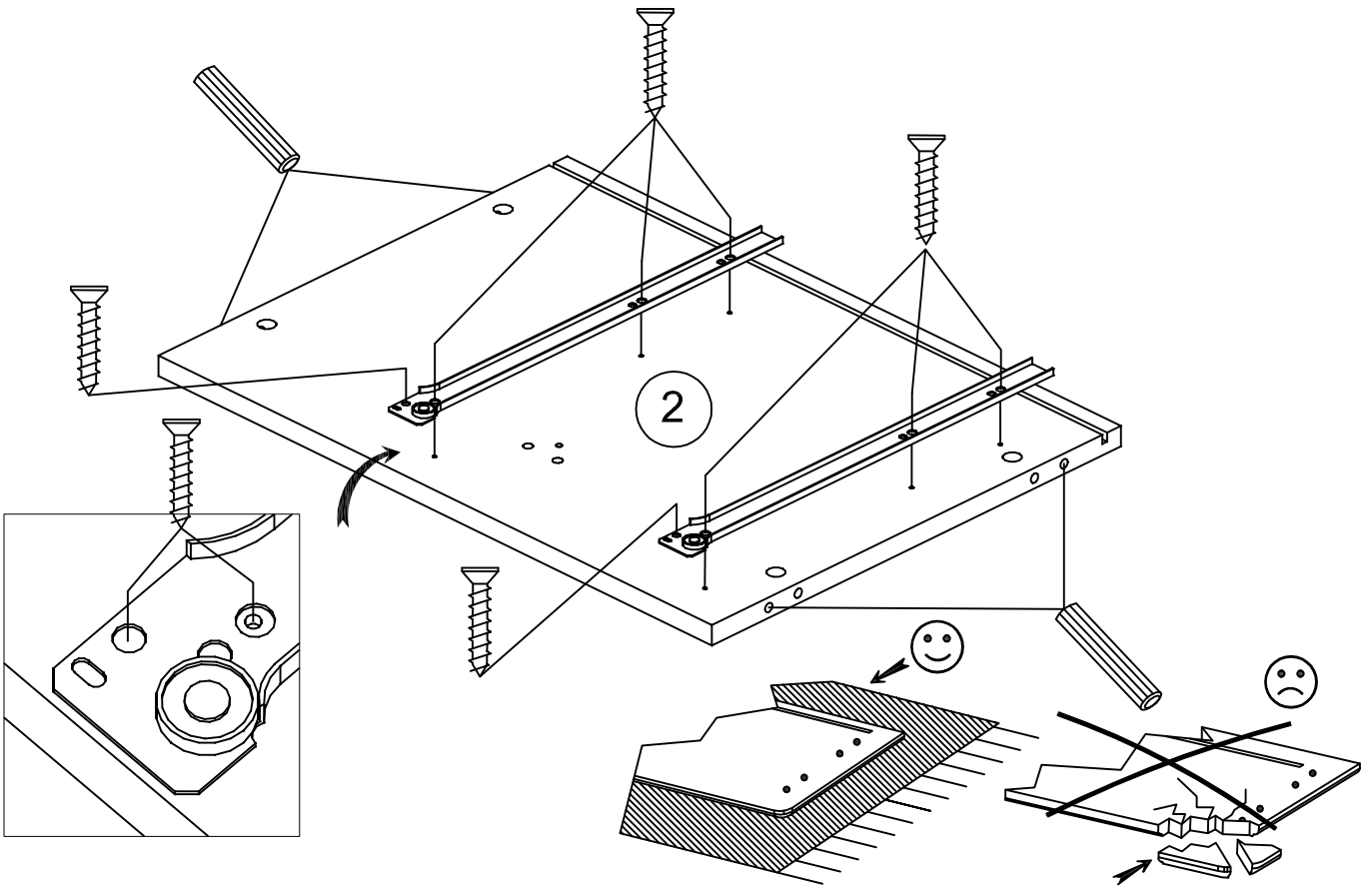

PHASE

17

AFL

L = 400

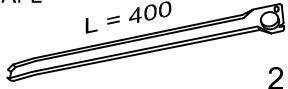

2

VI

3.5 X 15



8

ADm

30

Ø8

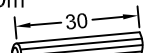

4

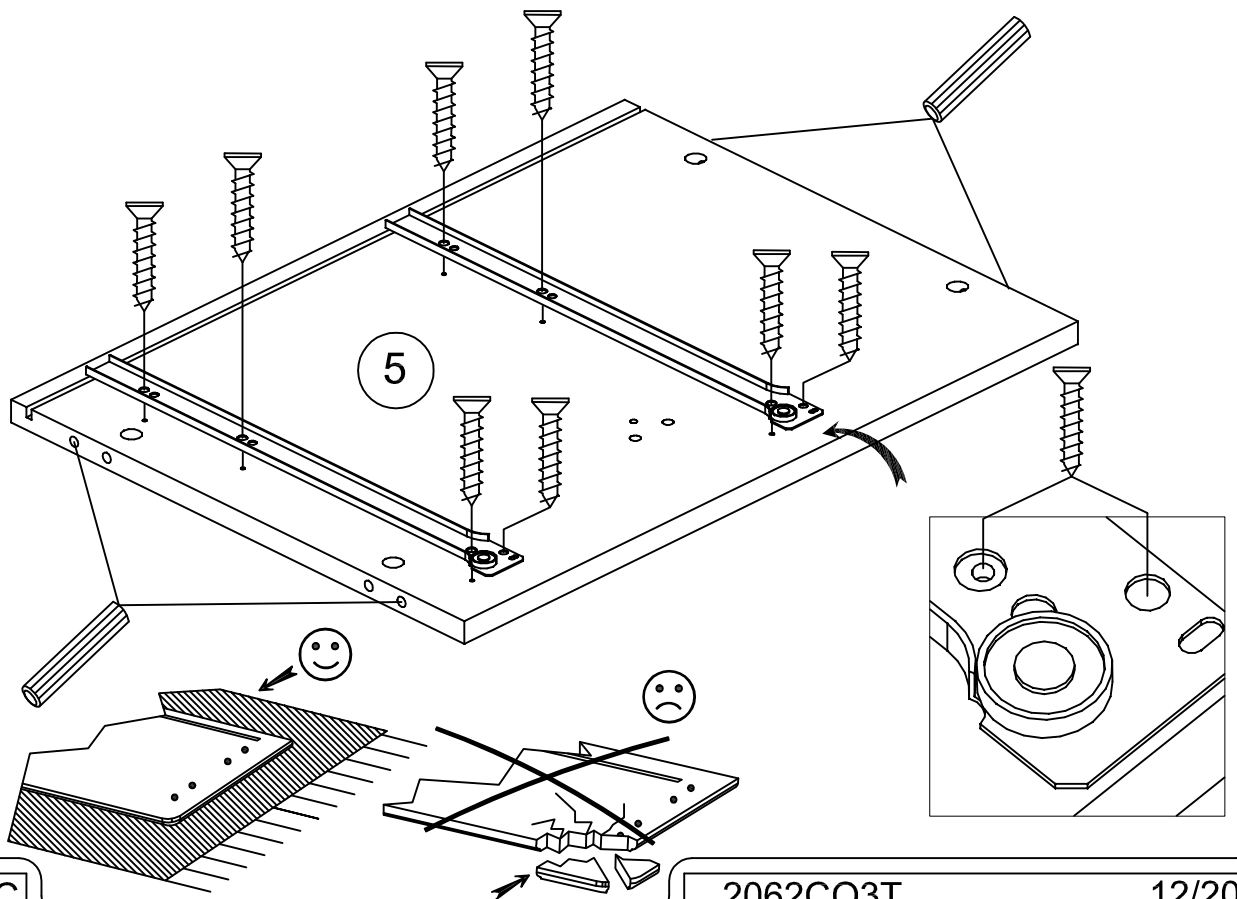

PHASE

18

AFL

L = 400

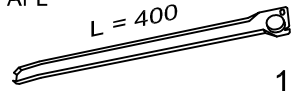

1

VI

3.5 X 15

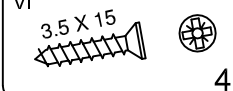

4

ADm

30 Ø8

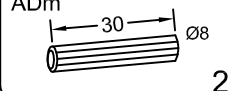

2

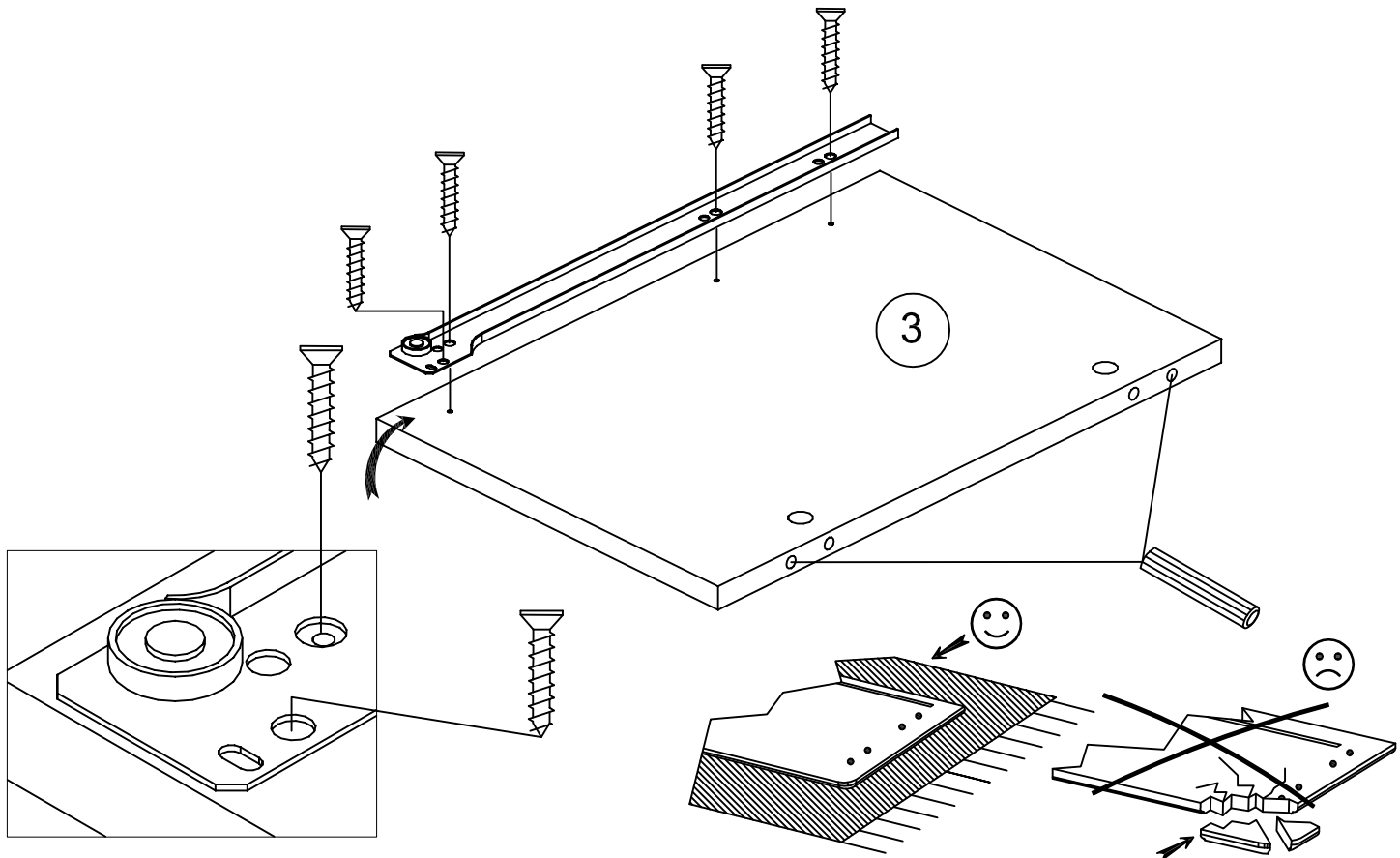

PHASE

19

AFK

L = 400

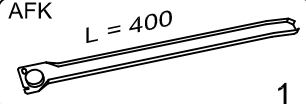

1

VI

3.5 X 15

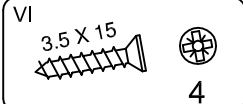

4

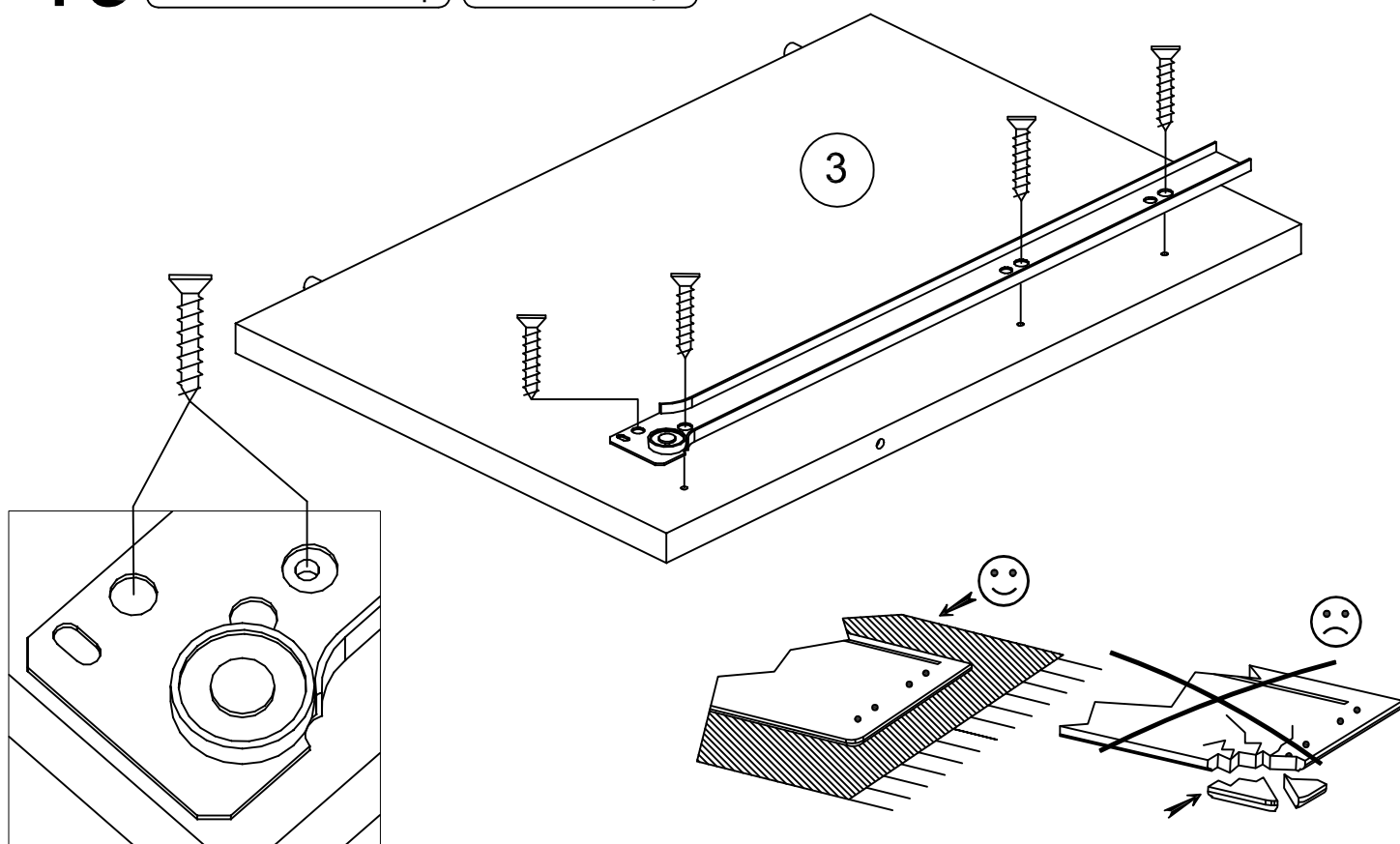

PHASE

20

BLL

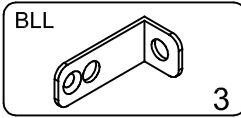

3

VB

6.5x12.5

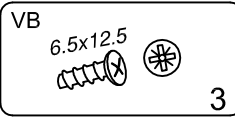

3

ADm

30 Ø8

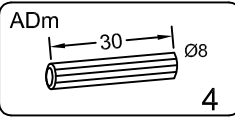

4

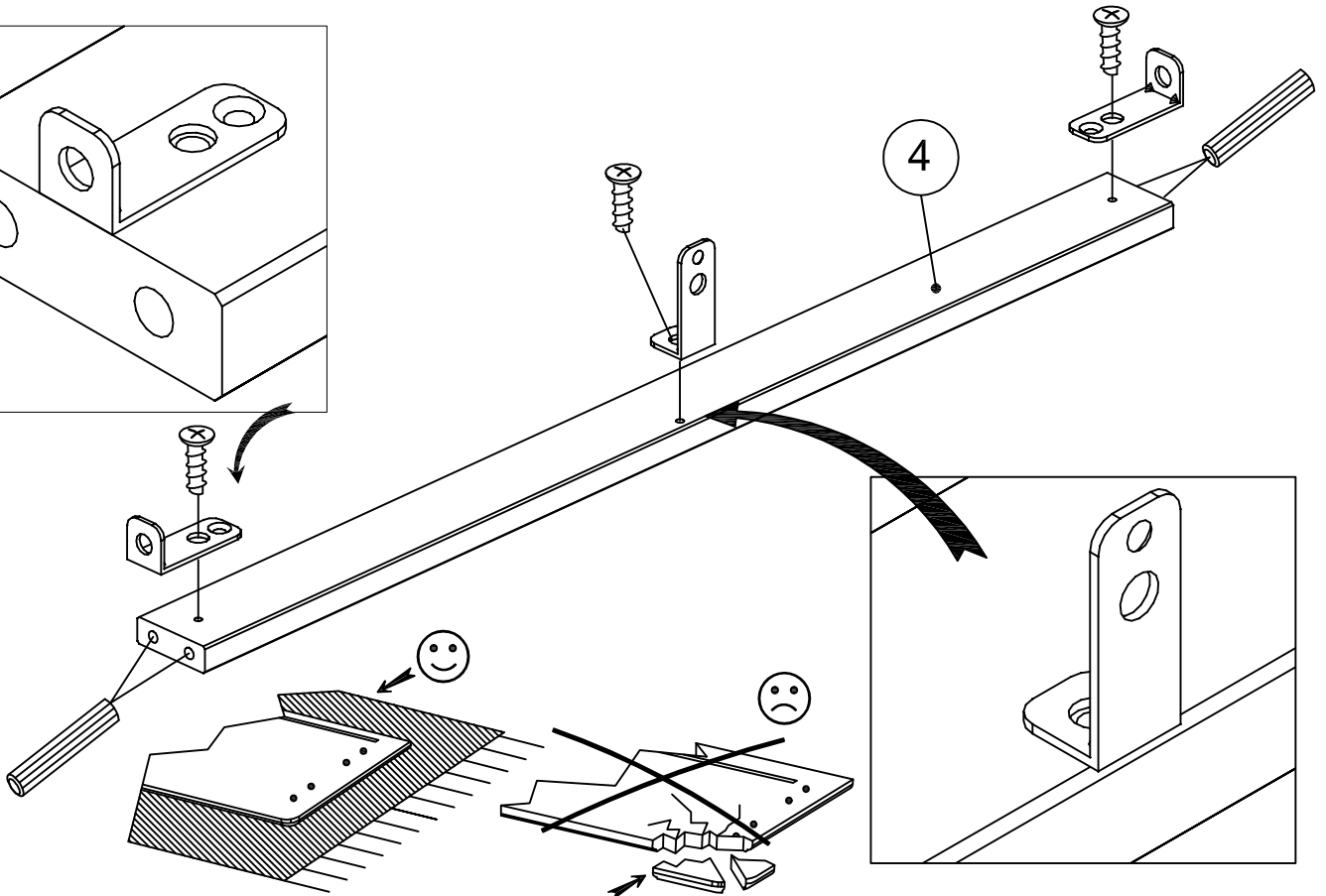
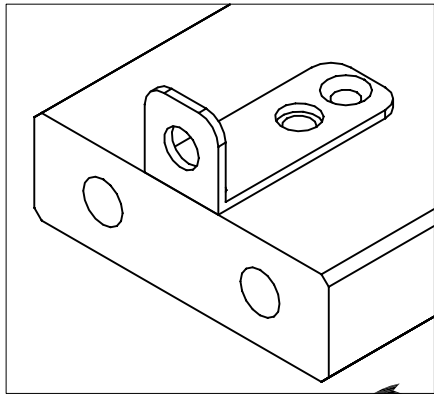

PHASE

21

Ai

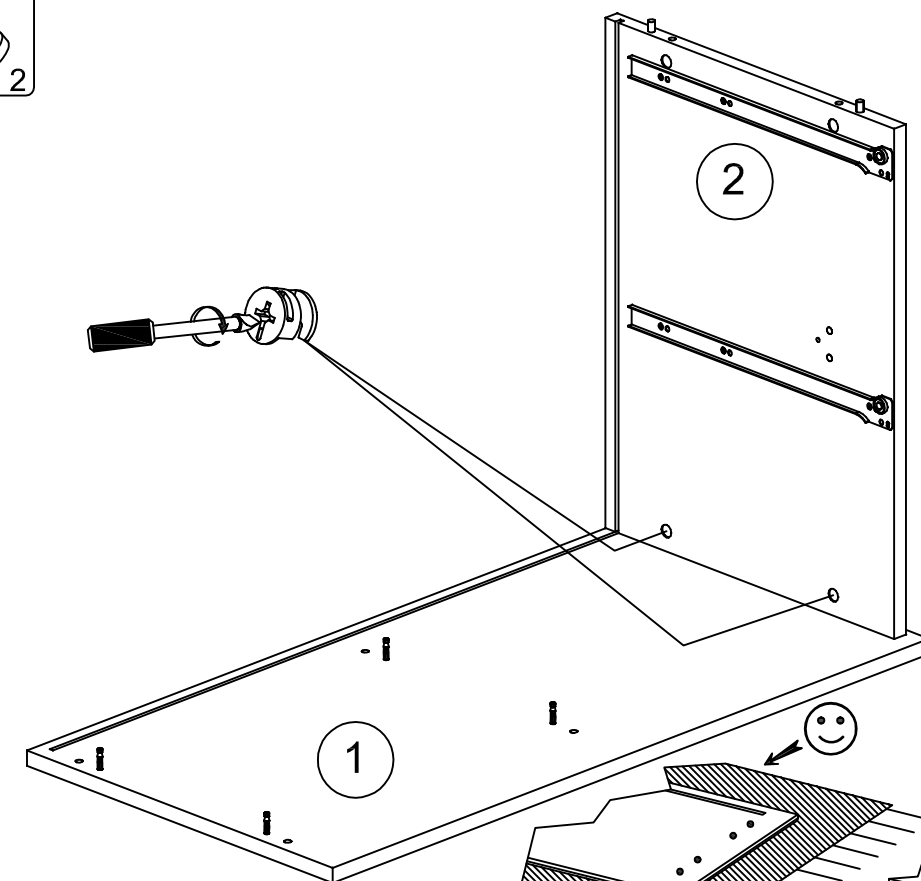
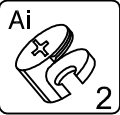

PHASE

22

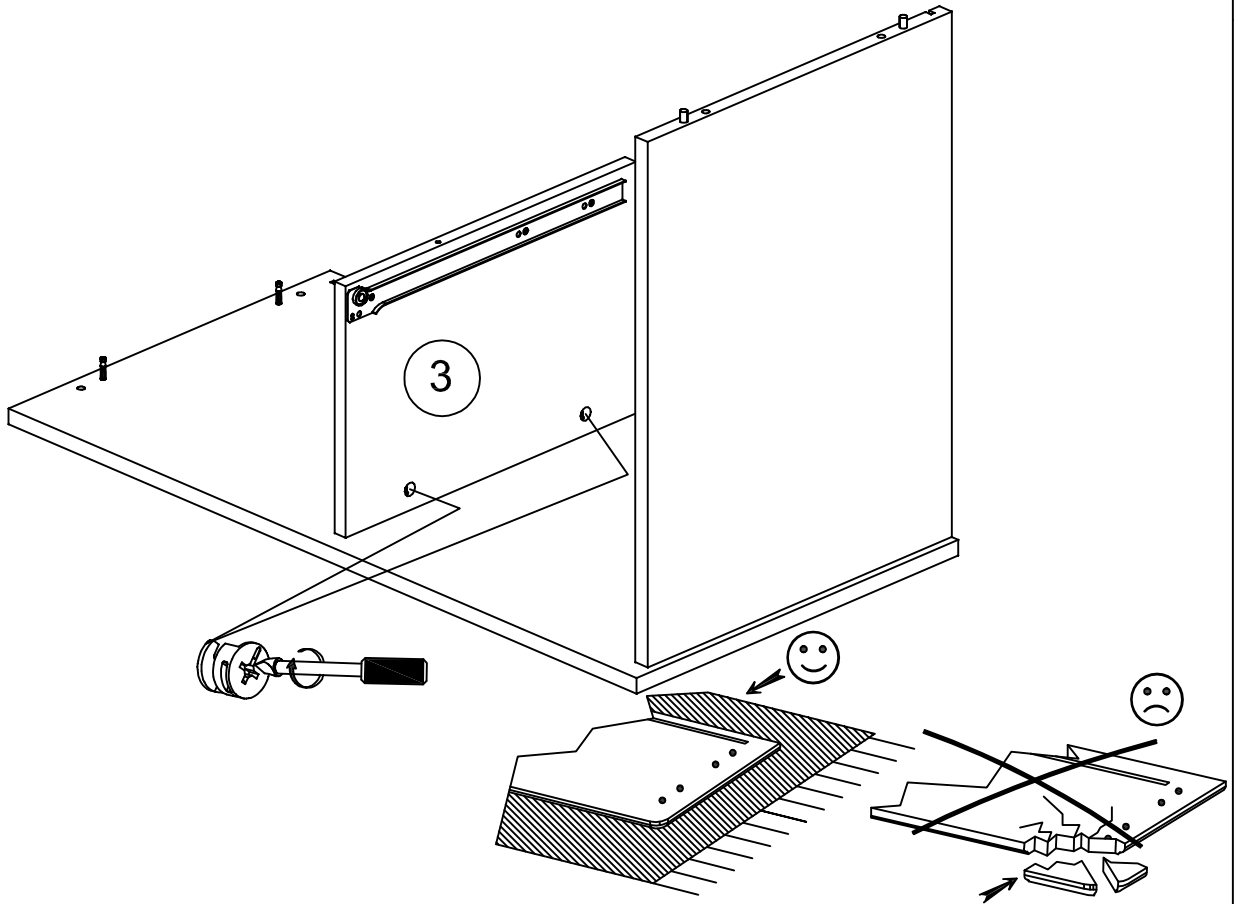
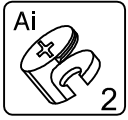

PHASE

23

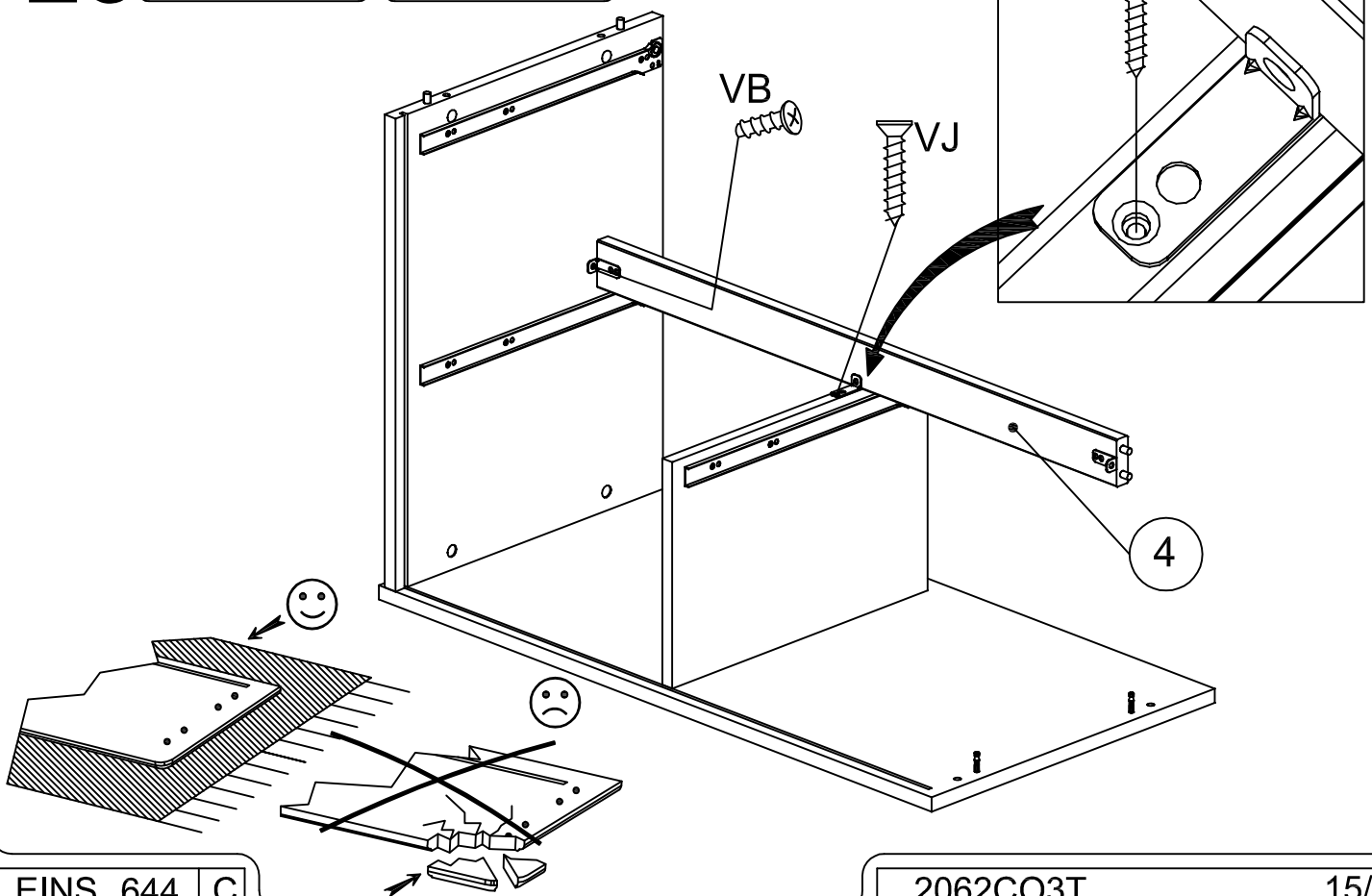
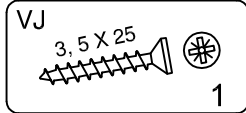
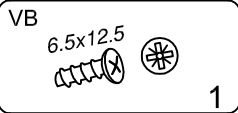

PHASE

24

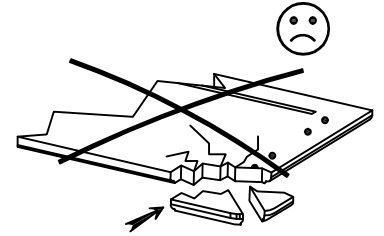
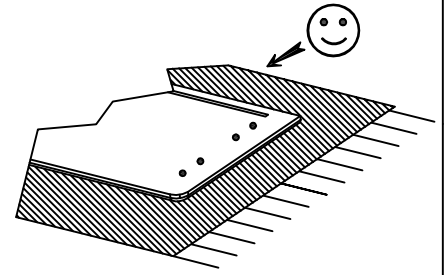
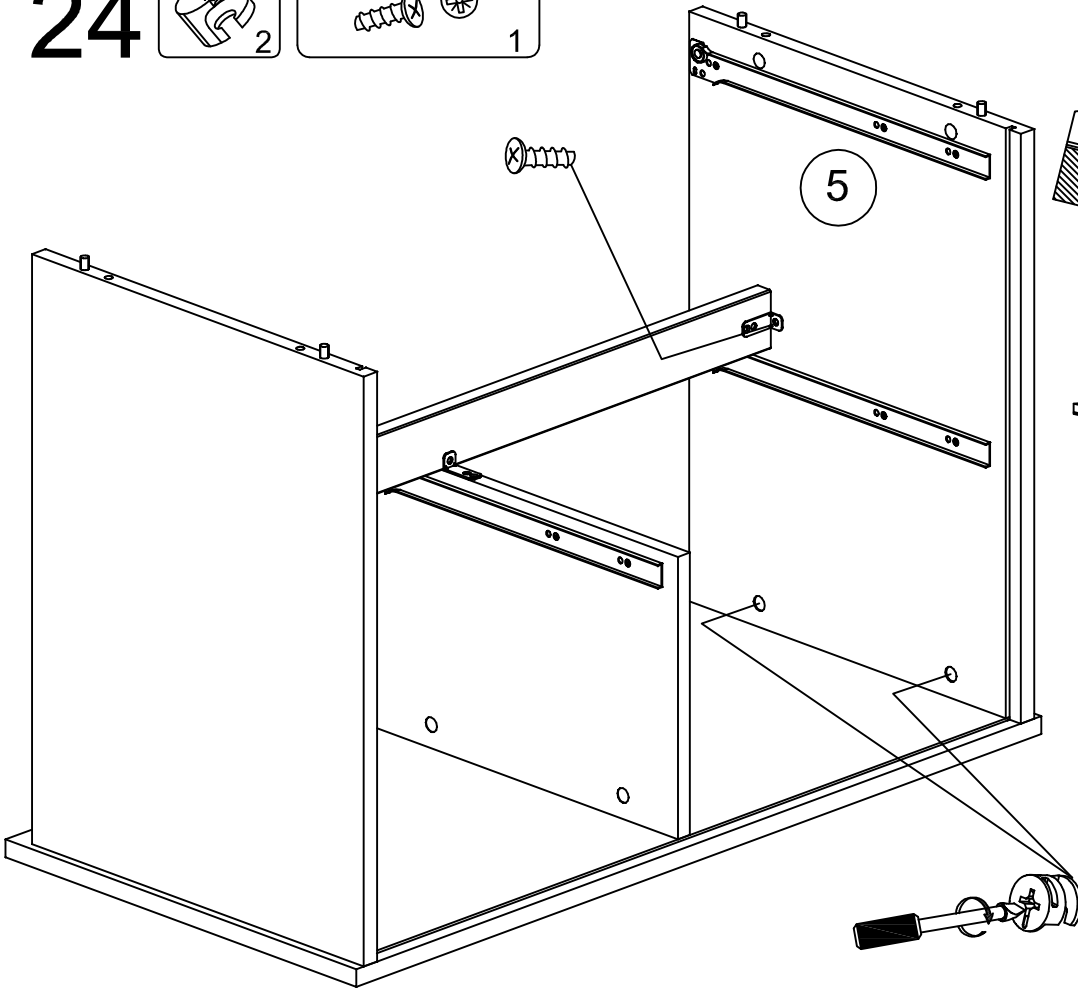
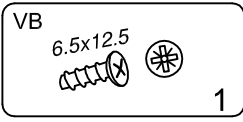
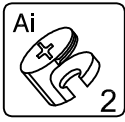

PHASE

25

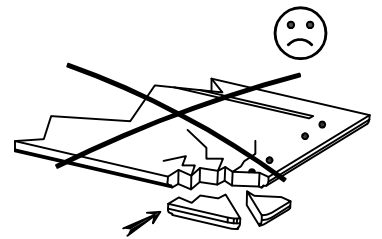
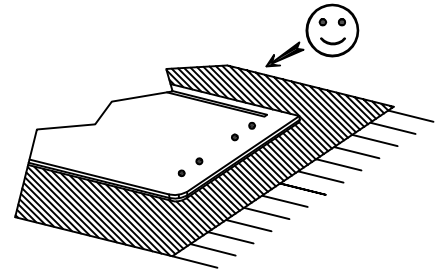
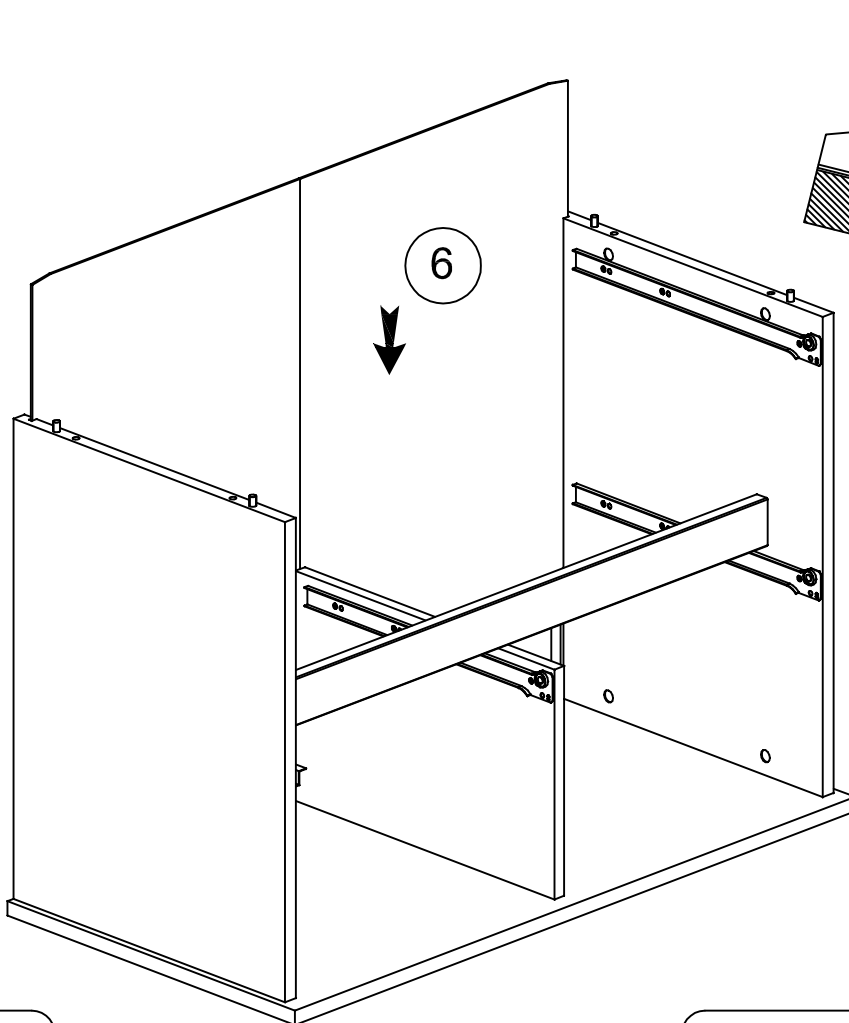

PHASE

26

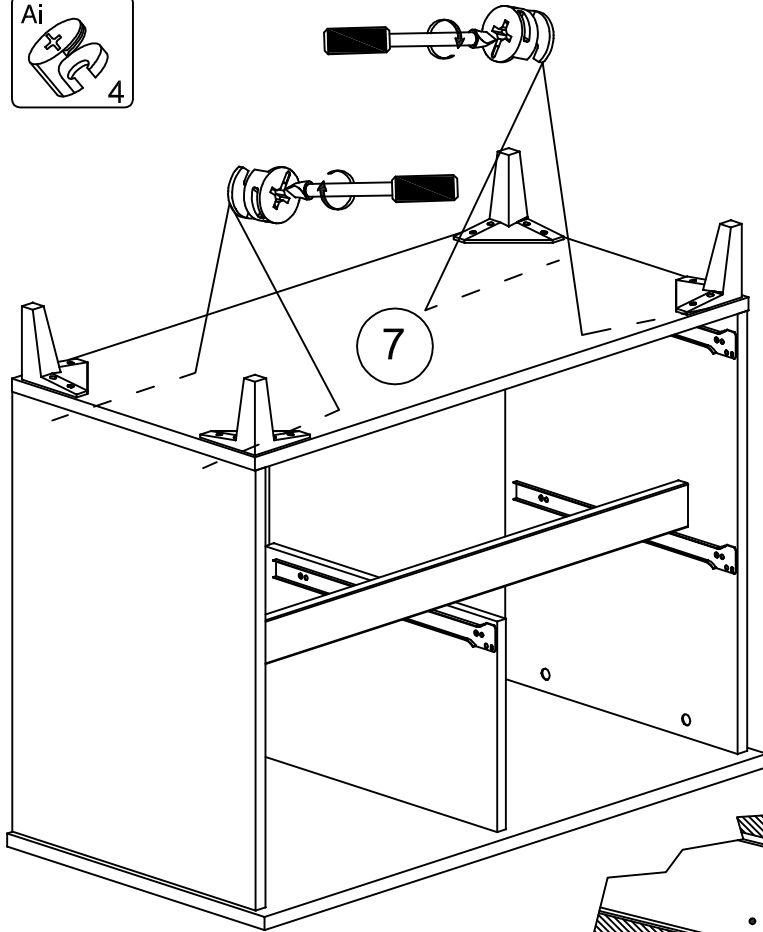
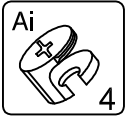

PHASE

27

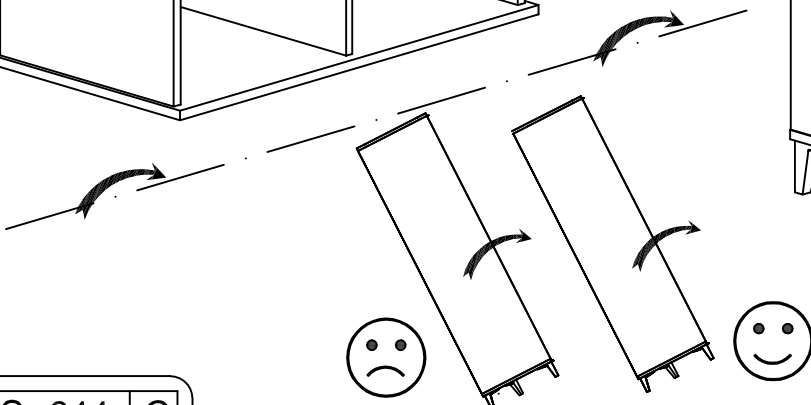
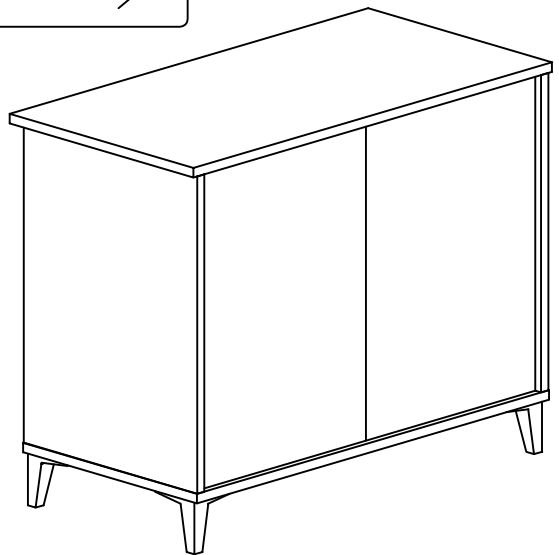
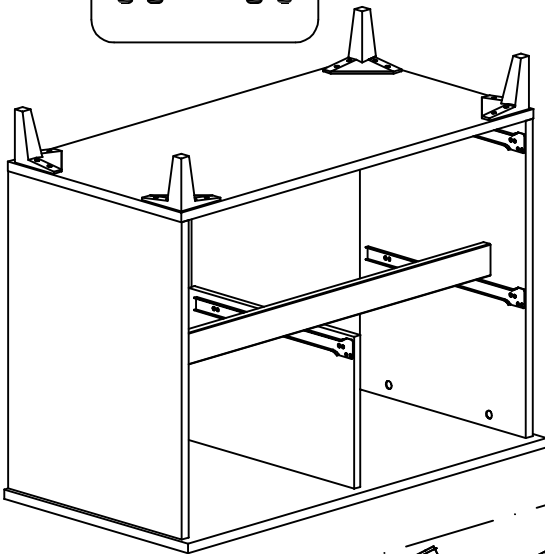
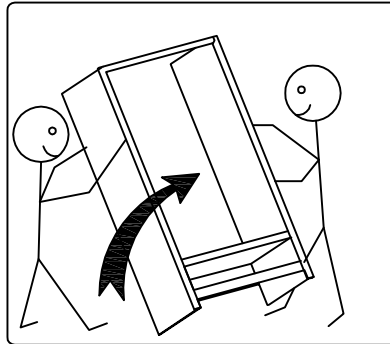

PHASE

28

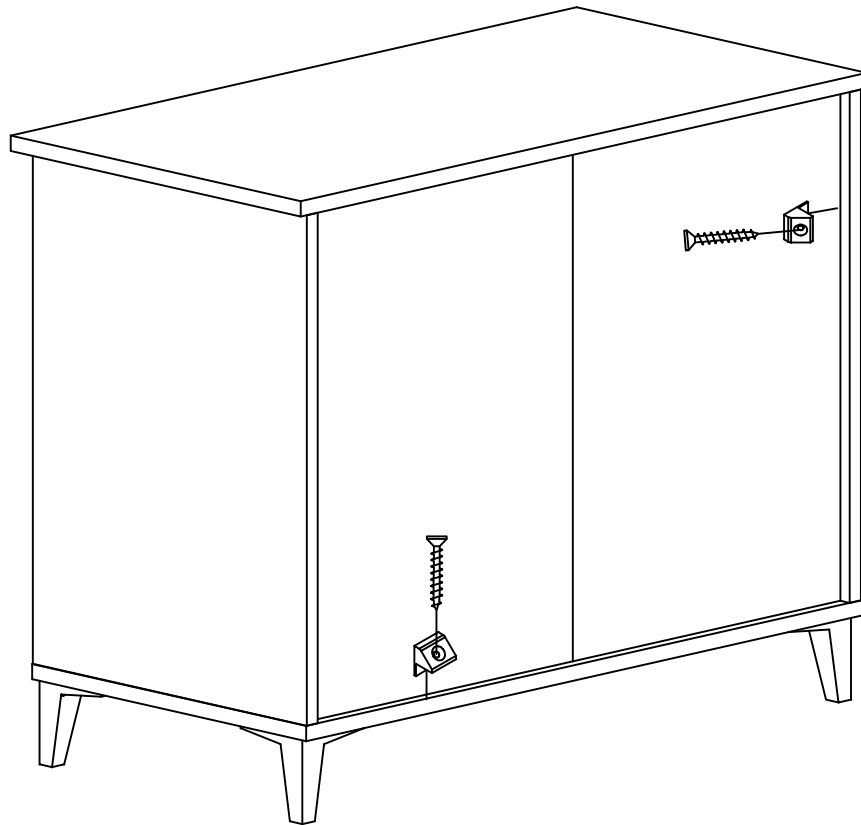
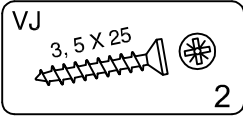

PHASE

29

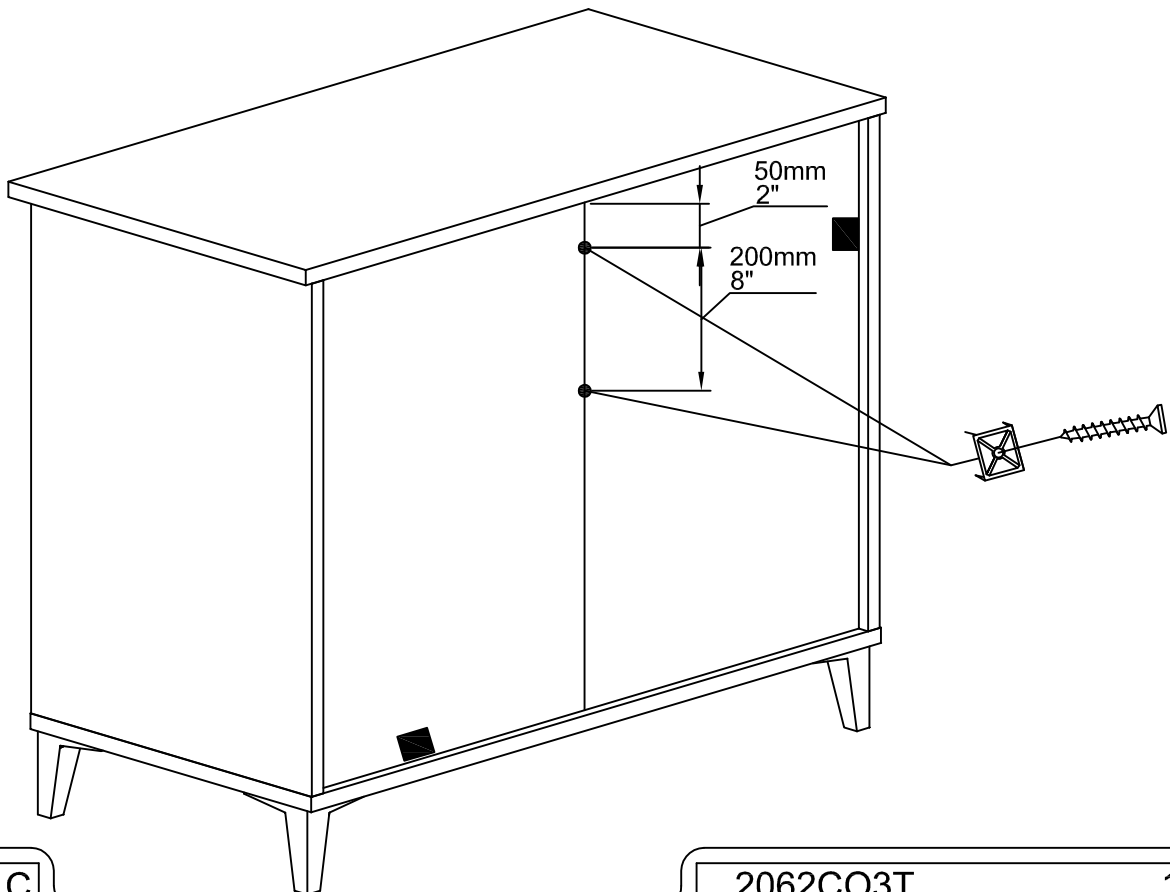
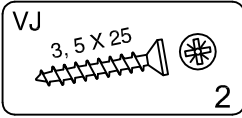
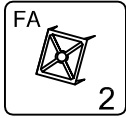

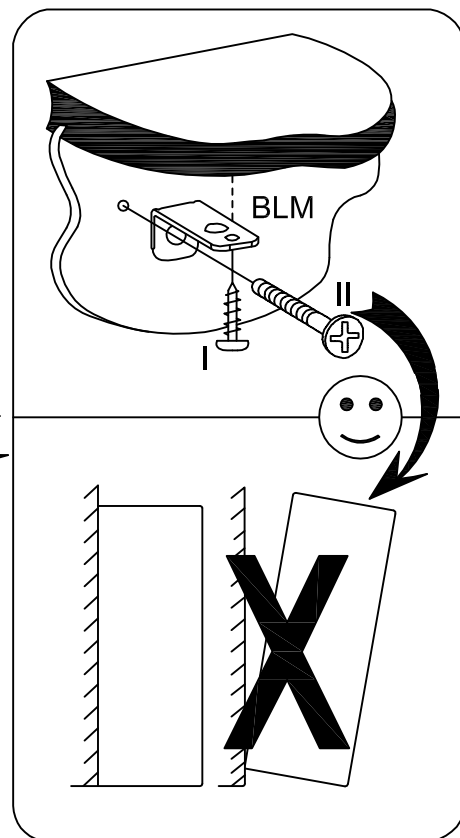
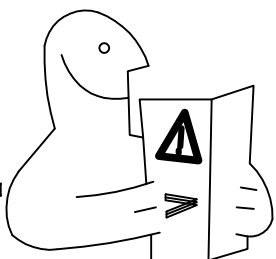
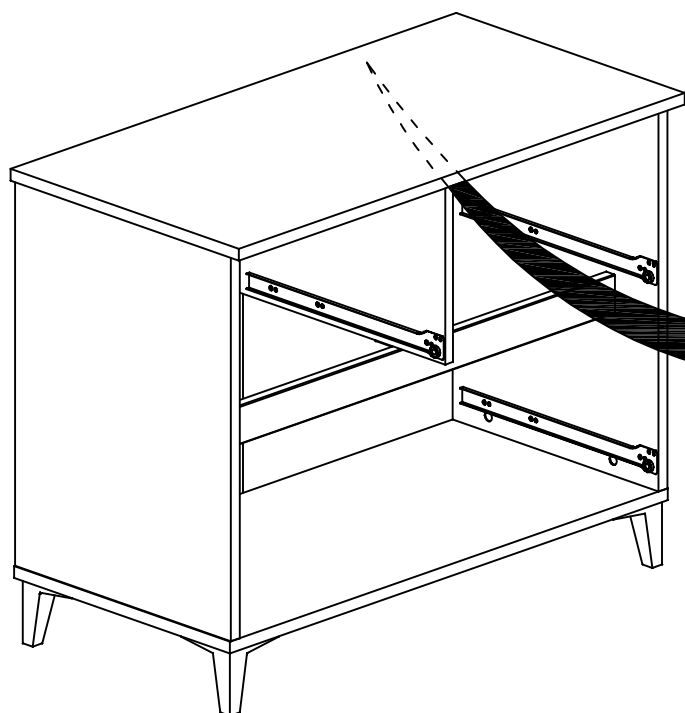
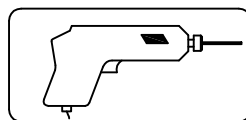
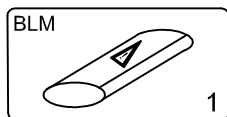

- (FR) Pour votre sécurité: Fixation du meuble au mur Attention, la fixation doit être réalisée par une personne compétente car cela nécessite des chevilles adaptés à la nature de votre mur.
- (GB) For your own safety: Attach the furniture to the wall. Important: The furniture must be attached by a qualified person using dowels that are suited to the type of wall.
- (D) Für ihre Sicherheit: Befestigung des Möbelstücks an der Wand Achtung, die Befestigung muss von einem Fachmann vorgenommen werden, weil sie an die Wand angepasste Dübel erfordert.
- (E) Para su seguridad: Fijación del meuble a la pared Ojo! La fijación deberá llevarla a cabo una persona competente ya que necesitará unos tacos adaptados a tipo de pared.
- (PT) Para a sua segurança: Fixação do móvel na parede. Atenção, a fixação deve ser efectuada por uma pessoa competente, pois exige a utilização de cavilhas adaptadas à natureza da parede.
- (I) Per la vostra sicurezza: Fissaggio del mobile alla parete. Nota bene, il fissaggio deve essere eseguito da personale specializzato, poiché l'utilizzo di tasselli adattati alla parete.
- (NL) Voor uw veiligheid: Bevestiging van het meubel aan de muur. Let op, de bevestiging moet worden uitgevoerd door een bevoegd persoon, want hiervoor zijn pluggen nodig die specifiek geschikt zijn voor de betreffende muur.

PHASE

31

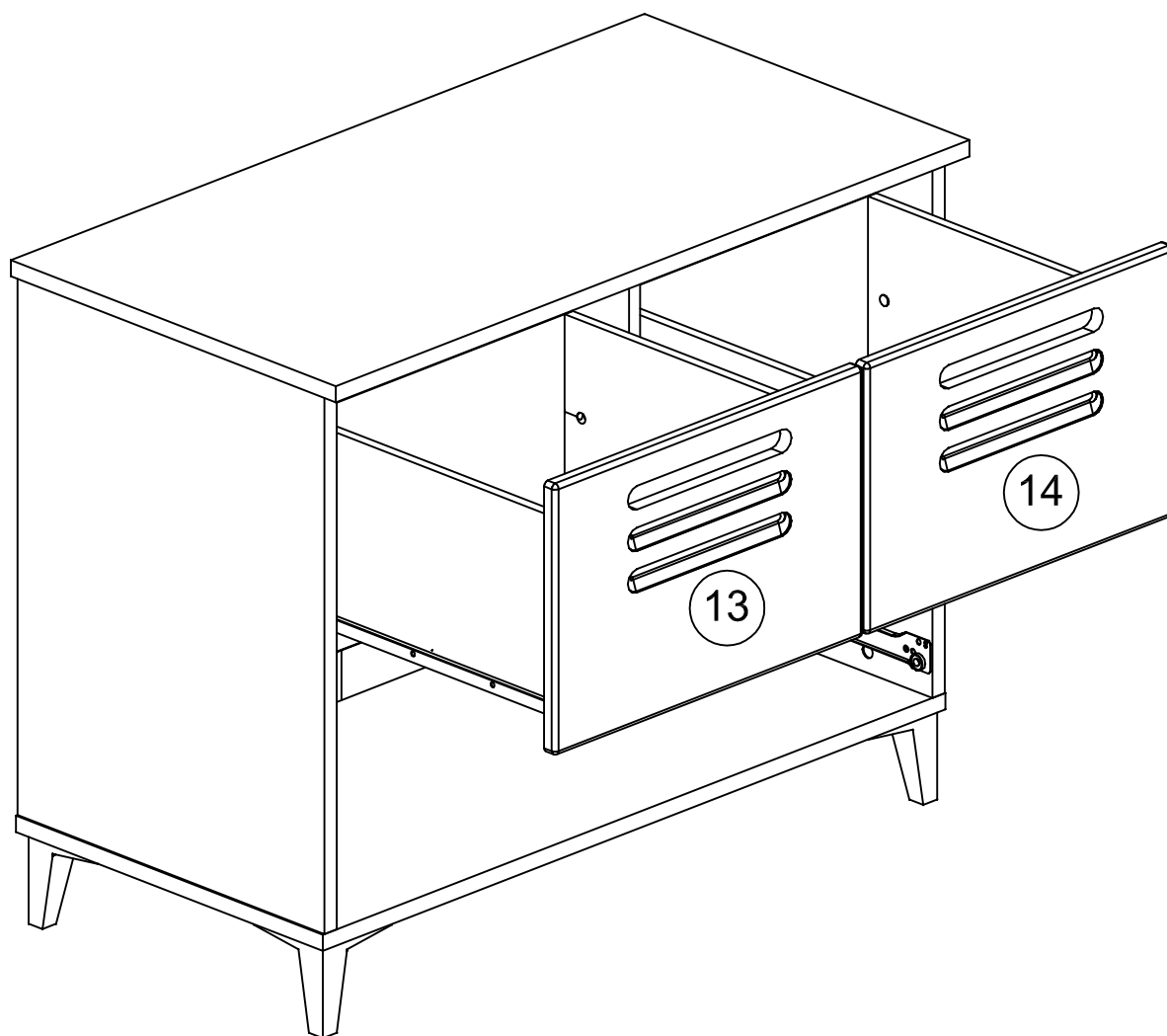

PHASE

32

